

DynaRound Hatch Guard

AVAILABLE THROUGH
TREMCO
ROOFING & BUILDING MAINTENANCE

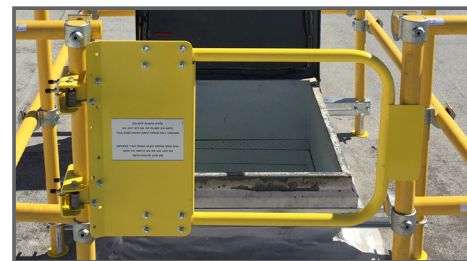

Self-closing gate prevents accidental entry.



Width adjustable to allow for hatch size variations.



Unique compression fit design. No drilling!



Rugged hinges allow gate tension adjustment.

All Rooftop entry/exit points must be protected. The DynaRound Hatch Guard provides a non-penetrating, affordable solution. With easy setup, our hatch protection system can be used for both temporary and permanent solutions. The adjustable, self-closing gate prevents accidental entrance.

The DynaRound Hatch Guard is designed to install quickly. The unique snap in place rails allow typical installation in less than 60 minutes with 2 people.

The DynaRound Hatch Guard mounts directly to the roof hatch with a compression fit design. No drilling necessary means rooftop water integrity is not compromised. Multiple sizes are available to fit almost any hatch. Yellow or gray FRP posts and guardrails with galvanized fittings and self closing gate ensure a long service life.

SPECIFICATIONS

Safety Ratings

OSHA Requirements:

- 1926.501(b)(4) • 1910.28(b)
- 1926.502(b) • 1910.29(b)

CAL/OSHA Requirements:

- 3209 • 3212

IBC 2015 Requirements:

- 1015.3 • 1015.7 • 1607.8.1.1
- 1015.4.4 • 1607.8.1 • 1607.8.1.2

National Building Code of Canada 2015

- 4.1.5.14 • 9.8.8.2

Benefits

- Fast Installation
- Rugged Design
- Compression Fit
- No Cutting or Drilling
- Self-Closing Gate
- FRP Posts and Rails
- No Roof Penetration
- Adjustable - Fits Nearly Any Roof Hatch
- Custom Configurations Available

Measurements

- Rail Heights
 - Top Rail Height: 42"
 - Mid Rail Height: 20"
- Multiple Sizes Available
 - 30-36" x 30-54"
 - 42-48" x 42-60"
 - 30-36" x 96-114"
- Custom Sizes Available

PRODUCT DATA SHEET

AVAILABLE THROUGH
TREMCO
ROOFING & BUILDING MAINTENANCE

Fibergrate
Composite Structures
Building the World to Last™

DYNAROUND RG™ (ROOF GUARD)

Fibergrate's ballasted rooftop guardrail system, DynaRound RG™, is designed for safety and fall protection on rooftop applications. Each system is made of durable, weather-resistant fiberglass reinforced plastic (FRP) composite uprights and non-FRP counterbalance weights and connector components. This system meets applicable safety standards in the U.S. and Canada to protect people working at heights.

DynaRound RG provides the utmost in safety by protecting against injuries or death from accidental falls from the roof. This system will help you meet OSHA regulations 1910.29(b) (1) through (b)(7) for unprotected sides and edges. This system also meets Section 4.1.5.14(1)(b) of the 2015 National Building Code of Canada. It offers superior protection around rooftop mechanical equipment that is within 10 feet of a roof edge, enabling your roof to comply with provision 1015.6 of the International Building Code. The counterweight system means there is no drilling into the roof to attach the system. This eliminates any damage to the roof that could result from the drilling, including potential sources of leaks.

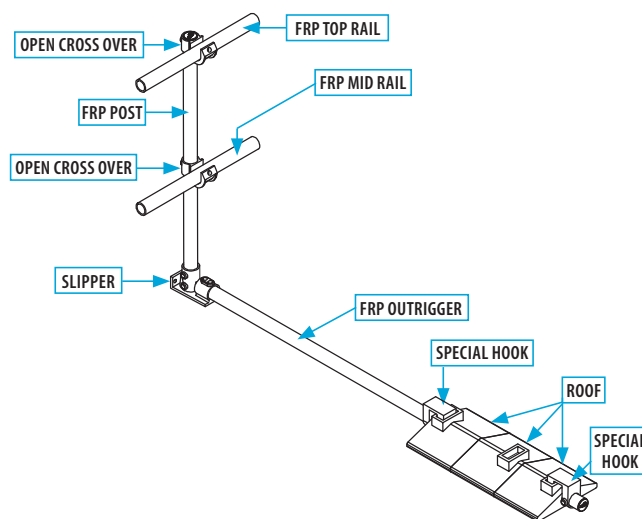

BENEFITS



Lightweight: Fibergrate FRP products lessen impact on rooftop installations, reduce installation time, can eliminate the need for heavy lifting equipment, and reduce shipping costs.



Long Service Life: Fiberglass products provide outstanding durability and corrosion resistance in demanding applications, providing improved product life over traditional materials.



UV Resistant: UV Inhibitors in the resin matrix, along with a synthetic surfacing veil, provide optimum protection from the effect of UV weathering. In addition, the FRP rails, posts, and outriggers have an additional UV coating suitable for intense UV exposure.



Low Install Cost: Prefabricated FRP components and connectors using set screws for assembly eliminate drilling and almost all field cutting for a rapid, clean installation.



Corrosion Resistant: Fibergrate® fiberglass products are known for their ability to provide corrosion resistance in the harshest environments.



Low Maintenance: The corrosion resistant properties of FRP are easy to clean and reduce or eliminate the need for sandblasting, scraping and painting.

SPECIFICATIONS

Safety Ratings

OSHA Requirements:

- 1926.501(b)(1)
- 1926.502(b)
- 1910.28(b)(1)
- 1910.29(b)

CAL/OSHA Requirements:

- 3210
- 3212
- 1620
- 3209

IBC 2015 Requirements:

- 1015.3
- 1015.4.4
- 1015.7
- 1607.8.1
- 1607.8.1.1
- 1607.8.1.2

National Building Code of Canada 2015

- 4.1.5.14
- 9.8.8.2

OH&S

- R.R.O. 1990, Reg. 851, s. 13 & 14

Materials of Construction

Rails, posts, and outriggers:

- VEFR (Vinyl ester resin system with a flame spread of 25 or less for dependable resistance to both acidic and alkaline environments)

Fittings and Counterbalance Weights:

- Galvanized, cast iron connectors with set screws
- Protective, durable rubber pads on parts that contact roof surface

Size

- 1.9" O.D. Pultruded Round Tube

Colors

Yellow with UV Coating

Light Gray with UV Coating

SYSTEM COMPONENTS

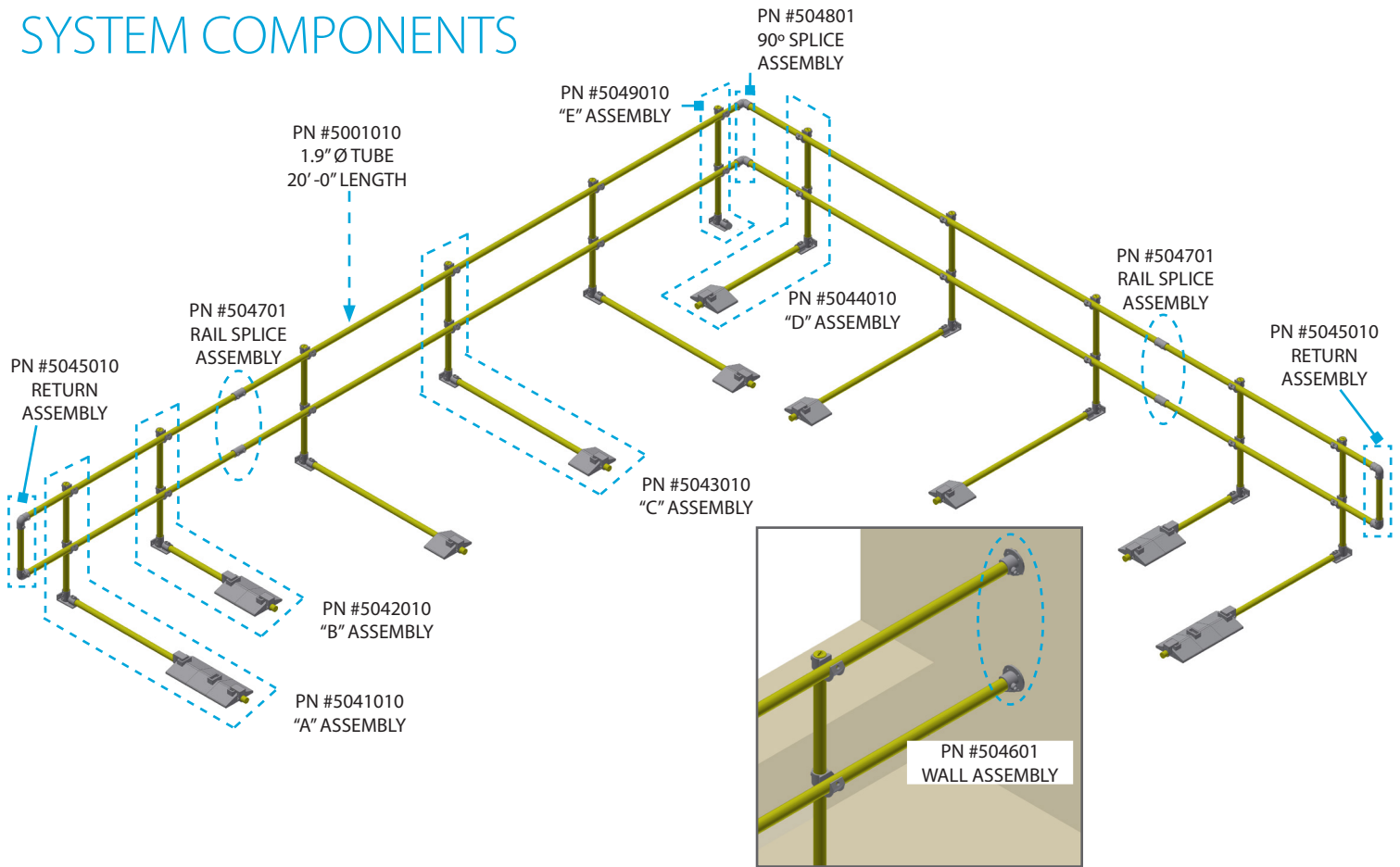

TYPICAL SPACING FOR ASSEMBLIES

RETURN CONDITION

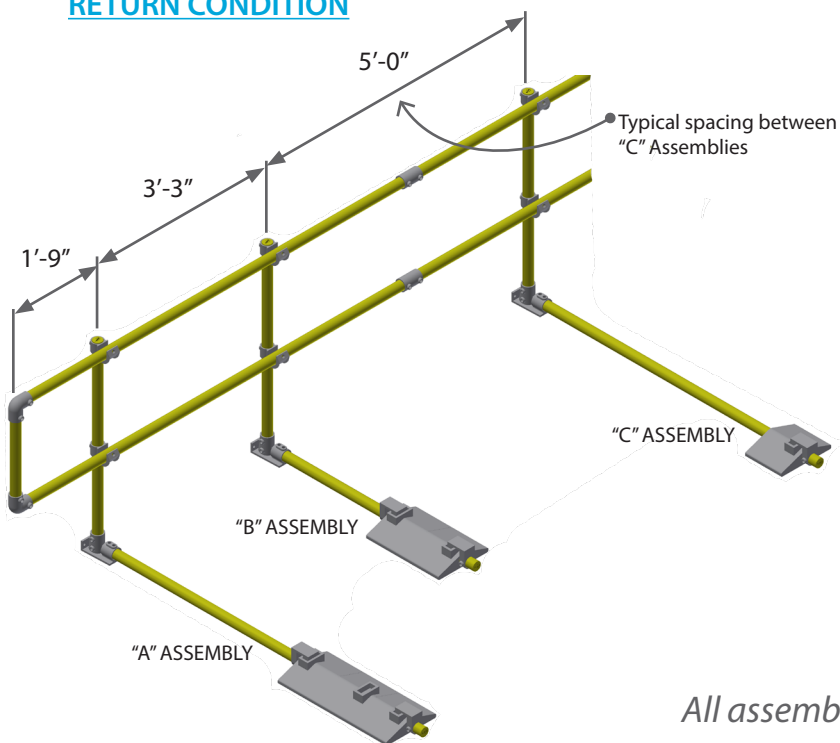

CORNER CONDITION

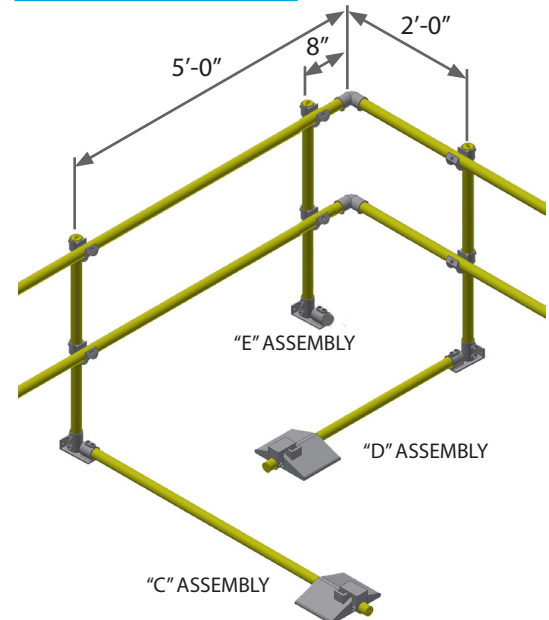

All assembly details can be found on the next page.

PRODUCT DATA SHEET

ASSEMBLY DETAILS

| "A" ASSEMBLY ITEM #5041010 | | |
|---------------------------------------|-----|---------|
| Weight = 147 lbs | | |
| DESCRIPTION | QTY | PN # |
| Post | 1 | 5040010 |
| Open Cross Over | 2 | 793201 |
| Slipper | 1 | 793206 |
| Roof Weight | 3 | 793208 |
| Special Hook | 2 | 793207 |
| A Outrigger (Length: 73") | 1 | 5041110 |

| "B" ASSEMBLY ITEM #5042010 | | |
|---------------------------------------|-----|---------|
| Weight = 105 lbs | | |
| DESCRIPTION | QTY | PN # |
| Post | 1 | 5040010 |
| Open Cross Over | 2 | 793201 |
| Slipper | 1 | 793206 |
| Roof Weight | 2 | 793208 |
| Special Hook | 2 | 793207 |
| B Outrigger (Length: 46-1/2") | 1 | 5042110 |

| "C" ASSEMBLY ITEM #5043010 | | |
|---------------------------------------|-----|---------|
| Weight = 65 lbs | | |
| DESCRIPTION | QTY | PN # |
| Post | 1 | 5040010 |
| Open Cross Over | 2 | 793201 |
| Slipper | 1 | 793206 |
| Roof Weight | 1 | 793208 |
| Special Hook | 1 | 793207 |
| C Outrigger (Length: 66") | 1 | 5043110 |

| "D" ASSEMBLY ITEM #5044010 | | |
|---------------------------------------|-----|---------|
| Weight = 62 lbs | | |
| DESCRIPTION | QTY | PN # |
| Post | 1 | 5040010 |
| Open Cross Over | 2 | 793201 |
| Slipper | 1 | 793206 |
| Roof Weight | 1 | 793208 |
| Special Hook | 1 | 793207 |
| D Outrigger (Length: 43") | 1 | 5044110 |

**PN #5040010
POST
(Length=42-1/8")**

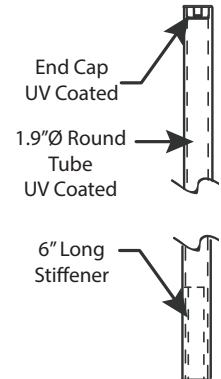

**PN #793201
OPEN CROSS OVER**

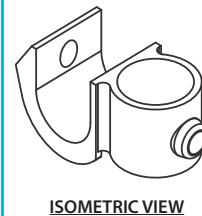

**PN #793207
SPECIAL HOOK***

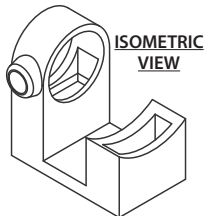

*Shown upside down

| "E" ASSEMBLY ITEM #5049010 | | |
|---------------------------------------|-----|---------|
| Weight = 15 lbs | | |
| DESCRIPTION | QTY | PN # |
| Post | 1 | 5040010 |
| Open Cross Over | 2 | 793201 |
| Slipper | 1 | 793206 |

| RETURN ASSEMBLY ITEM #5045010 | | |
|--|-----|---------|
| Weight = 6 lbs | | |
| DESCRIPTION | QTY | PN # |
| Return (Length: 21-1/16") | 1 | 5045110 |
| Two Way Elbow | 2 | 793125 |

| WALL ASSEMBLY ITEM #504601 | | |
|---------------------------------------|-----|--------|
| Weight = 4 lbs | | |
| DESCRIPTION | QTY | PN # |
| Base Flange | 2 | 793131 |

| 90° SPLICE ASSEMBLY ITEM #504801 | | |
|---|-----|--------|
| Weight = 4 lbs | | |
| DESCRIPTION | QTY | PN # |
| Two Way Elbow | 2 | 793125 |

| RAIL SPLICE ASSEMBLY ITEM #504701 | | |
|--|-----|--------|
| Weight = 3 lbs | | |
| DESCRIPTION | QTY | PN # |
| Sleeve Joint | 2 | 793149 |

**PN #5045110
RETURN (Length = 21-1/16")**

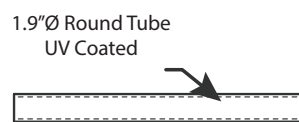

**OUTRIGGER -
SEE EACH ASSEMBLY DETAIL
FOR PN# LENGTHS**

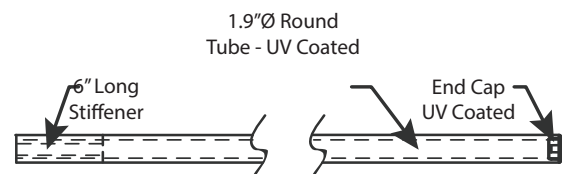

**PN #793206
SLIPPER**

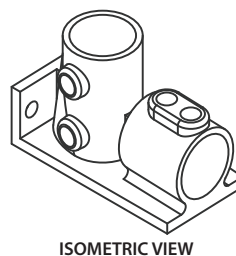

**PN #793208
ROOF WEIGHT**

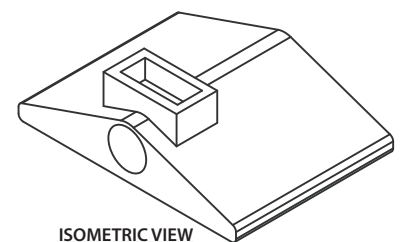

**PN #793125
TWO WAY ELBOW**

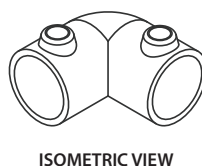

**PN #793131
BASE FLANGE**

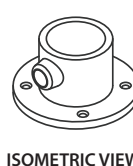

**PN #793149
SLEEVE JOINT**

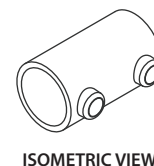

**PN #793126
SWIVEL ELBOW**

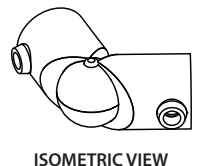

PRODUCT DATA SHEET

AVAILABLE THROUGH
TREMCO
ROOFING & BUILDING MAINTENANCE

Fibergrate
Composite Structures
Building the World to Last™

DYNAROUND RG (ROOF GUARD) SLIMLINE™

Fibergrate's new ballasted rooftop guardrail system, DynaRound RG Slimline™, provides safety and fall protection on rooftop applications. While our RG system utilizes counter balance bases, the SlimLine systems uses both counterbalance bases in addition to circular galvanized bases with less interference. Similar to our DynaRound RG system, each Slimline system is made of durable, weather-resistant fiberglass reinforced plastic (FRP) composite uprights and rails, galvanized steel base weights, and galvanized connector components. This system meets applicable safety standards in the U.S. and Canada to protect people working at heights.

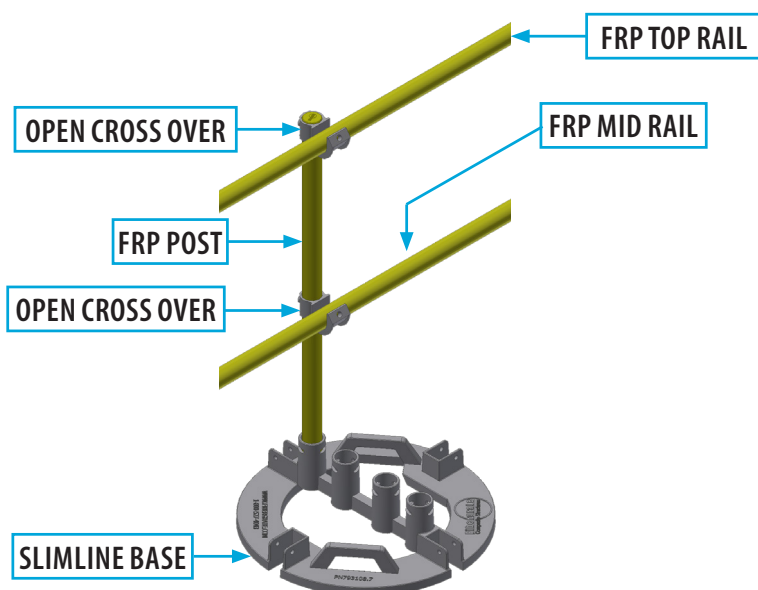

DynaRound RG Slimline provides the utmost in safety by protecting against injuries or death from accidental falls from the roof. The weighted base system means there is no drilling into the roof to attach the system. This eliminates any damage to the roof that could result from the drilling, including potential sources of leaks.

SPECIFICATIONS

Safety Ratings

OSHA Requirements:

- 1926.501(b)(1)
- 1926.502(b)
- 1910.28(b)(1)
- 1910.29(b)

CAL/OSHA Requirements:

- 3210
- 3212
- 1620
- 3209

IBC 2015 Requirements:

- 1015.3
- 1015.7
- 1015.4.4
- 1607.8.1
- 1607.8.1.1
- 1607.8.1.2

National Building Code of Canada 2015

- 4.1.5.14
- 9.8.8.2

OH&S

- R.R.O. 1990, Reg. 851, s. 13 & 14

Materials of Construction

Rails, posts, and outriggers:

- VEFR (Vinyl ester resin system with a flame spread of 25 or less for dependable resistance to both acidic and alkaline environments)

Fittings and Base Weights:

- Galvanized, cast iron connectors with set screws
- Protective, durable rubber pads on parts that contact roof surface

BENEFITS OF FRP



Corrosion Resistant: Fibergrate® fiberglass products are known for their ability to provide corrosion resistance in the harshest environments.



Lightweight: Fibergrate FRP products lessen impact on rooftop installations, reduce installation time, can eliminate the need for heavy lifting equipment, and reduce shipping costs.



Low Maintenance: The corrosion resistant properties of FRP are easy to clean and reduce or eliminate the need for sandblasting, scraping and painting.



Long Service Life: Fiberglass products provide outstanding durability and corrosion resistance in demanding applications, providing improved product life over traditional materials.



Electrically & Thermally Non Conductive: Fiberglass is electrically non conductive for safety and has low thermal conductivity - resulting in a more comfortable product when physical contact occurs.



UV Resistant: The FRP rails, post, and outriggers have additional factory applied coating suitable for daily UV exposure - further reducing the low cost of maintenance.



DynaRound RG SlimLine Galvanized Base

Size

- 1.9" O.D. Pultruded Round Tube

Colors

Yellow with UV Coating

Light Gray with UV Coating



SYSTEM COMPONENTS

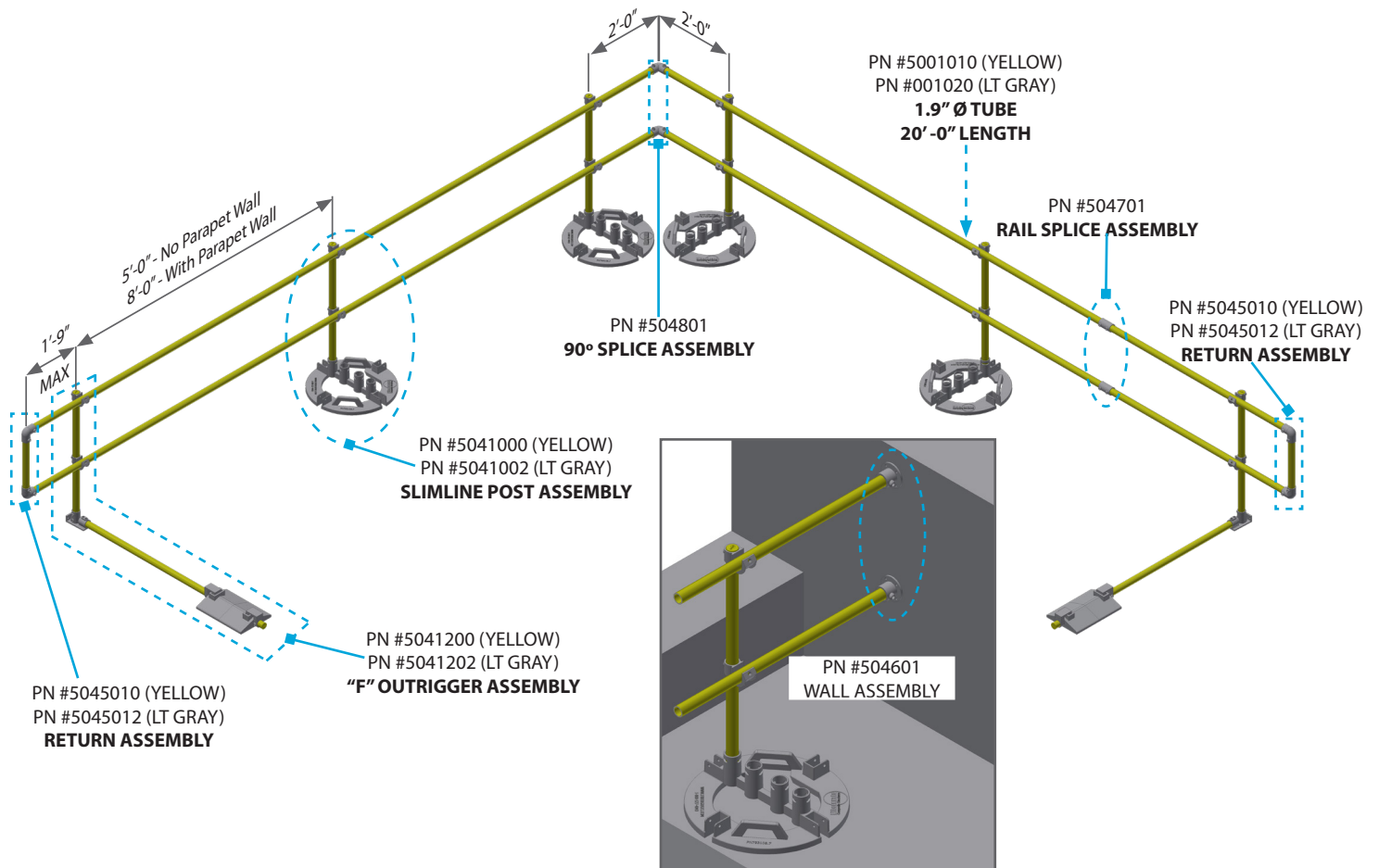

TYPICAL SPACING FOR ASSEMBLIES

RETURN CONDITION

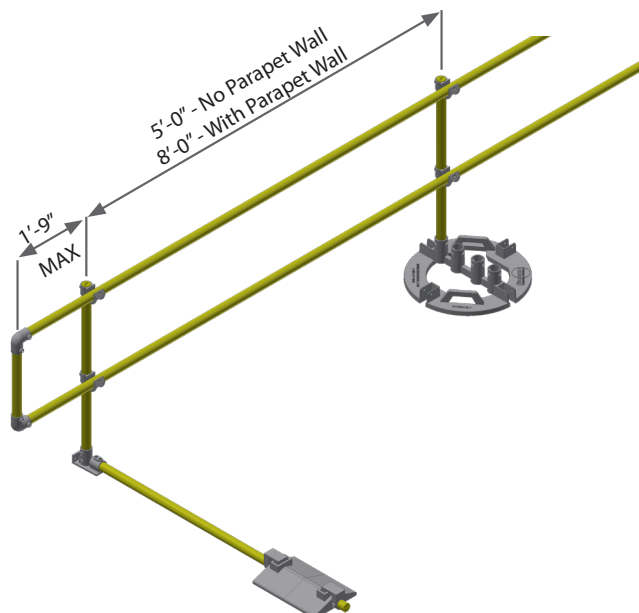

KICKER ASSEMBLY

(A kicker assembly can be used as an alternative to the standard "F" outrigger.)

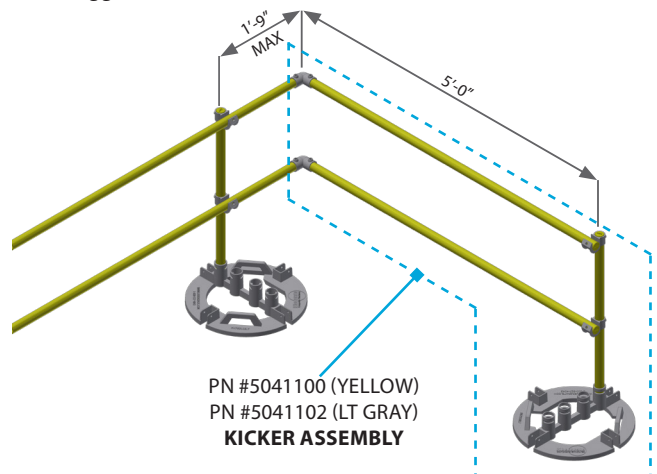

All assembly details can be found on the next page.

Phone: 800-852-6013 | Email: SafetySolutions@tremcoinc.com | www.tremcoroofing.com

ASSEMBLY DETAILS

| DynaRound SL Post Assembly, Yellow ITEM #5041000 | | |
|---|-----|----------|
| Weight = 97 lbs | | |
| DESCRIPTION | QTY | PN # |
| DynaRound SL Post - YL | 1 | 5041610 |
| Open Cross Over | 2 | 793201 |
| Lock Pin | 1 | 793108.2 |
| DynaRound SL Base | 1 | 793108.7 |

| DynaRound SL Post Assembly, LT GRAY ITEM #5041002 | | |
|--|-----|----------|
| Weight = 97 lbs | | |
| DESCRIPTION | QTY | PN # |
| DynaRound SL Post - GR | 1 | 5041612 |
| Open Cross Over | 2 | 793201 |
| Lock Pin | 1 | 793108.2 |
| DynaRound SL Base | 1 | 793108.7 |

| DynaRound SL Kicker Assembly, Yellow ITEM #5041100 | | |
|---|-----|----------|
| Weight = 110 lbs | | |
| DESCRIPTION | QTY | PN # |
| DynaRound SL Post - YL | 1 | 5041610 |
| Open Cross Over | 2 | 793201 |
| Lock Pin | 1 | 793108.2 |
| DynaRound SL Base | 1 | 793108.7 |
| Two Way Elbow | 2 | 793125 |
| DynaRound SL Kicker Rail - YL | 2 | 5041710 |

| DynaRound SL Kicker Assembly, LT GRAY ITEM #5041102 | | |
|--|-----|----------|
| Weight = 110 lbs | | |
| DESCRIPTION | QTY | PN # |
| DynaRound SL Post - LG | 1 | 5041612 |
| Open Cross Over | 2 | 793201 |
| Lock Pin | 1 | 793108.2 |
| DynaRound SL Base | 1 | 793108.7 |
| Two Way Elbow | 2 | 793125 |
| DynaRound SL Kicker Rail - LG | 2 | 5041712 |

| DynaRound SL 'F' Outrigger Assy, Yellow ITEM #5041200 | | |
|--|-----|---------|
| Weight = 108 lbs | | |
| DESCRIPTION | QTY | PN # |
| DynaRound RG Post - YL | 1 | 5040010 |
| Open Cross Over | 2 | 793201 |
| Slipper | 1 | 793206 |
| Roof | 2 | 793208 |
| Special Hook | 2 | 793207 |
| F Outrigger (L = 66") - YL | 1 | 5043110 |

| DynaRound SL 'F' Outrigger Assy, LT GRAY ITEM #5041202 | | |
|---|-----|---------|
| Weight = 108 lbs | | |
| DESCRIPTION | QTY | PN # |
| DynaRound RG Post - LG | 1 | 5040012 |
| Open Cross Over | 2 | 793201 |
| Slipper | 1 | 793206 |
| Roof | 2 | 793208 |
| Special Hook | 2 | 793207 |
| F Outrigger (L = 66") - LG | 1 | 5043112 |

| Swivel Elbow Assembly ITEM #504802 | | |
|---------------------------------------|-----|--------|
| Weight = 4 lbs | | |
| DESCRIPTION | QTY | PN # |
| Swivel Elbow | 2 | 793126 |

| WALL ASSEMBLY ITEM #504601 | | |
|-------------------------------|-----|--------|
| Weight = 4 lbs | | |
| DESCRIPTION | QTY | PN # |
| Base Flange | 2 | 793131 |

| RAIL SPLICE ASSEMBLY ITEM #504701 | | |
|--------------------------------------|-----|--------|
| Weight = 3 lbs | | |
| DESCRIPTION | QTY | PN # |
| Sleeve Joint | 2 | 793149 |

| 90° SPLICE ASSEMBLY ITEM #504801 | | |
|-------------------------------------|-----|--------|
| Weight = 4 lbs | | |
| DESCRIPTION | QTY | PN # |
| Two Way Elbow | 2 | 793125 |

| RETURN ASSEMBLY, Yellow ITEM #5045010 | | |
|--|-----|---------|
| Weight = 6 lbs | | |
| DESCRIPTION | QTY | PN # |
| Return (Length: 21-1/16") | 1 | 5045110 |
| Two Way Elbow | 2 | 793125 |

| RETURN ASSEMBLY, LT GRAY ITEM #5045012 | | |
|---|-----|---------|
| Weight = 6 lbs | | |
| DESCRIPTION | QTY | PN # |
| Return (Length: 21-1/16") | 1 | 5045112 |
| Two Way Elbow | 2 | 793125 |

PN # 5041610/5041612
DYNAROUND SL POST
(LENGTH = 41-1/4")

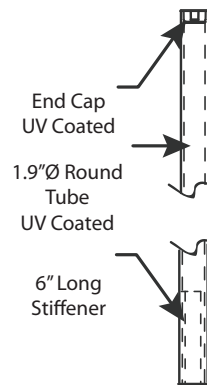

PN #793201
OPEN CROSS OVER

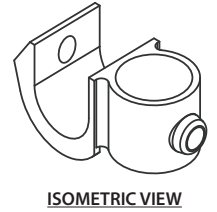

ISOMETRIC VIEW

PN #793207
SPECIAL HOOK*

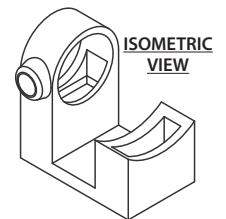

ISOMETRIC VIEW

*Shown upside down

PN #793125
TWO WAY ELBOW

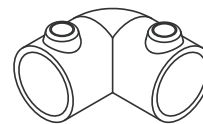

ISOMETRIC VIEW

PN #793206
SLIPPER

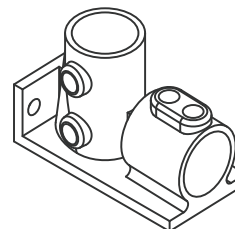

ISOMETRIC VIEW

PN #5045110
RETURN (Length = 21-1/16")

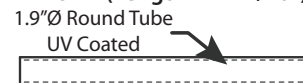

PN #793126
SWIVEL ELBOW

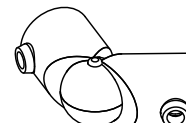

ISOMETRIC VIEW

PN #793131
BASE FLANGE



ISOMETRIC VIEW

PN #793149
SLEEVE JOINT

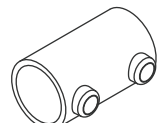

ISOMETRIC VIEW

PN #5043110/5043112
F OUTRIGGER
(LENGTH=66")

1.9"Ø Round
Tube - UV Coated

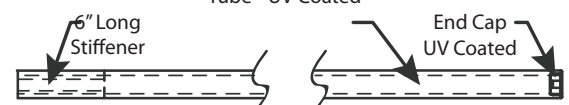

PN #793208
ROOF WEIGHT

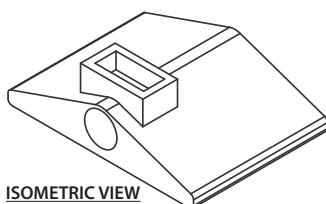

ISOMETRIC VIEW

PN #793108.7
DynaRound SL Base
Diameter=24"

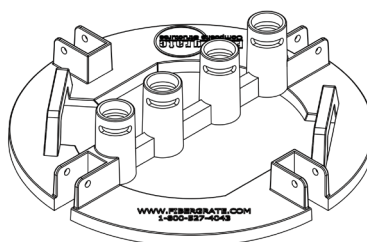

ISOMETRIC VIEW

DynaRound Warning Lines

AVAILABLE THROUGH
TREMCO
ROOFING & BUILDING MAINTENANCE



HEAVY-DUTY (HD) WARNING LINES



A permanent warning system with heavy-duty base plates, plastic coated cable and rigid, plastic pennants. The heavy-duty stanchions and bases are designed to withstand years of use. The standard system includes 3 stanchions, 3 bases, and 100 feet of cable with plastic flags.

SPECIFICATIONS

Safety Ratings

OSHA Requirements:

- 1926.501(b)(10)
- 1910.28(b)(8)(ii)
- 1926.502(f)
- 1910.29(d)

OH&S

- R.R.O. 1990, Reg. 851, s. 85 (b)(i)

Alberta OSHA 2009

- Section 161

Features and Benefits

- Permanent warning line system used for visual warning of at risk areas
- Uses heavy-duty, galvanized, weighted bases; steel cable; and rigid, plastic pennants
- Stanchions and bases can be purchased individually for non-linear installations requiring multiple turns.

Components

Set up with a Base Plate Every 30' with Pennants

Standard kit includes:

- 3 - 42" Stanchions
- 3 - Base Plates
- 100' of Plastic Coated Cable

LIGHT-DUTY (LD) WARNING LINES



Generally used for temporary warning line applications, our LD system features folding stanchions with a nylon line and vinyl flags that can be set up quickly. Create a safe-zone using the LD Warning Line System. The lightweight folding stanchions and flagged nylon cord allow for easy installation in a snap. Add the optional transporter for the ultimate in storage and portability. Typical installation for warning lines requires lines be placed a minimum of 6 feet from hazard for construction applications. (See your individual state OSHA regulations for compliance.)

SPECIFICATIONS

Safety Ratings

OSHA Requirements:

- 1926.501(b)(10)
- 1910.28(b)(8)(ii)
- 1926.502(f)
- 1910.29(d)

OH&S

- R.R.O. 1990, Reg. 851, s. 85 (b)(i)

Alberta OSHA 2009

- Section 161

Features and Benefits

- Foldable warning line system used for visual warning of at risk areas
- Standard system includes 3 folding bases and 100 feet of flags
- Optional transporter holds up to 9 folding warning line systems
- Optional rubber feet attachments

Components

Standard Kit Includes:

- 3 - 39.5" Tall Stanchions, 48" x 45" Footprint, 36 lbs
- 100 Feet of Nylon Flagged Line with Flags Every 5'
- Nylon Cord Rated at 657 lbs. Tensile Strength

DynaWeight Fall Protection System

The new DynaWeight Fall Protection System is the perfect solution for fall protection when circumstances require non-penetrating versatility. This non-penetrating counterweight system sets up quickly and is easy to move.

Non-Penetrating Versatility

The fall protection system is a free standing counterweight design that can be placed on flat surfaces with a maximum incline of 5 degrees. Tested and approved for multiple surfaces such as single ply, BUR, concrete, and modified bitumen membranes. DynaWeight meets fall-arrest ratings for one person weighing up to 310 lbs (including equipment).

Modular Design

The fall protection system's modular design makes installation easy. The base is set in place and the individual counterweights are stacked into position. No component of DynaWeight weighs more than 57 lbs, so it can be installed by most employees.

Mobility

With the patented, optional transport cart, the system can be moved to a new location quickly and safely by a single person.

Built to Last

Whether you transport the fall protection system from job to job or use it as a permanent tie off on your rooftop, this system is built to last. With corrosion resistant components, the system will provide maintenance free service for years to come.

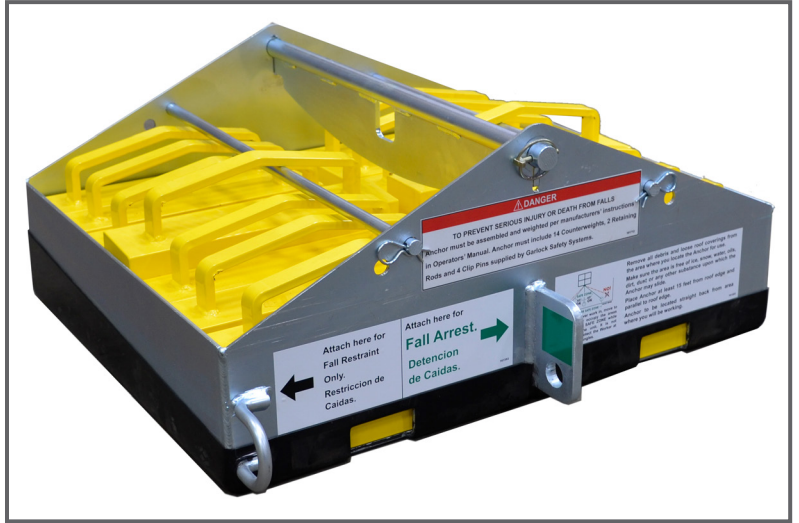

Your lanyard can connect to either the fall-restraint or the fall-arrest.



Optional Transport Cart



To move cart, position cart, raise DynaWeight, and move to new location.

SPECIFICATIONS

Safety Ratings

OSHA Requirements:

- 1926.501(b)(1)
- 1910.29(j)
- 1910.28(b)(1)
- 1910.140
- 1926.502(d)

CAL/OSHA Requirements:

- 1670(11) A-D

OH&S

- R.R.O. 1990, Reg. 851, s. 85 (b)(i)

Features

- Galvanized weight pan with durable rubber bottom

Tie-off points for:

- (1) person fall restraint rated AND (1) person fall arrest rated OR
- (2) person fall restraint

Approved Surface Use:

- Poured Concrete, EDPM (adhered & loose laid), TPO (adhered & loose laid), BUR (swept), AlphaGuard™ BIO, AlphaGuard™ MT/MTS, and AlphaGuard™ PUMA

Measurements

Total Weight

- 926 lbs

Base

- Dimensions:
- 28.5" x 24" x 13" (L x W x H)
- Counterweights:
- 14 required x 58 lbs each = 812 lbs

Transport Cart

- Dimensions
- 97" x 58" x 24" (L x W x H)
- Weight
- 112 lbs

PRODUCT DATA SHEET

AVAILABLE THROUGH
TREMCO
ROOFING & BUILDING MAINTENANCE

Fibergrate
Composite Structures
Building the World to Last™

FIBERPLATE® STAIR TREAD COVERS



Fiberplate® stair tread covers are a convenient way to provide solid, slip resistant footing for existing treads that are still structurally sound. Stair tread covers may be installed over wood, concrete or metal steps. Standard color is dark gray with a highly visible safety yellow nosing for industrial applications.

An integral aluminum oxide grit-top surface provides secure footing for maximum safety and a highly durable tread. Reinforced with a woven glass mat for durability and impact resistance, these tread

covers come in 8", 9", 10", 11" and 12" depths. The standard thickness is 1/8", with 1/4" thick covers available for heavy duty applications. Standard 12' panels are easily cut to size during installation, or are available pre-cut to custom lengths.

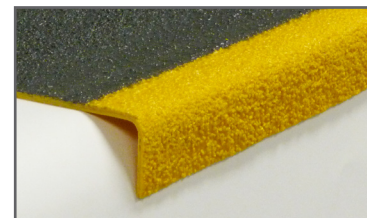

BENEFITS



Slip Resistant

The integrally applied aluminum oxide quartz grit top surface of stair treads covers have unmatched slip resistance for improved worker safety.



Low Install Cost

Due to ease of fabrication and lightweight, FRP stair tread covers eliminate the need for heavy lifting equipment and make installation easy.



Corrosion Resistant

Fiberplate® fiberglass stair tread covers are known for their ability to withstand the harshest environments and remain durable.

INSTALLATION INFORMATION

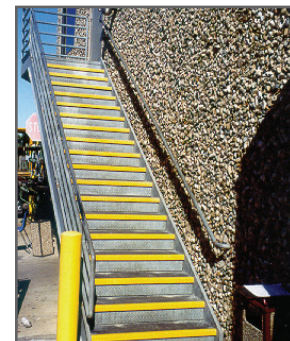
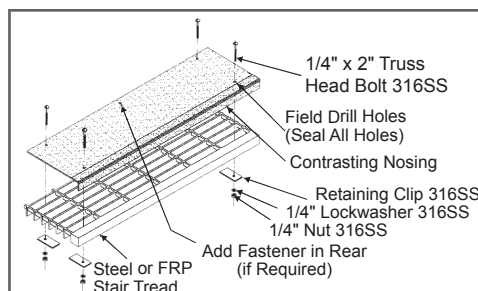
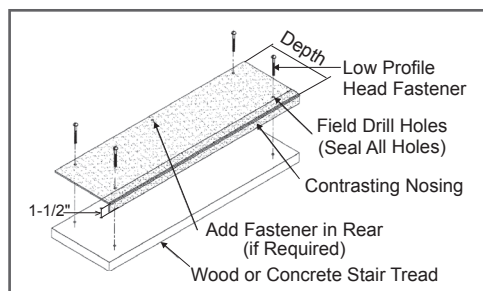

SPECIFICATIONS

Resin

Corvex®:

This newly improved isophthalic polyester resin system outperforms a number of competitive fiberglass and metal products and meets the requirements for corrosion resistance found in industrial, chemical processing and water/wastewater applications. *This upgraded formulation has replaced IFR, CP-84 and FS-25 resins.* Flame Spread: ASTM E84 rating of 25 or less. Certifications: DNV Type Approval No. F-16856; meets the USCG requirements for general fire rating*.

*For specific requirements and questions, please contact technical services.

Colors

Dark Gray

Yellow

Size

| THICKNESS | TREAD DEPTHS | STD. LENGTH |
|-----------|-----------------------|-------------|
| 1/8" | 8", 9", 10", 11", 12" | 12' |
| 1/4" | 8", 9", 10", 11", 12" | 12' |

Surface

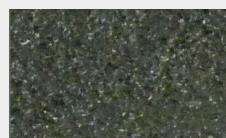

Aluminum Oxide Grit:

Aluminum oxide quartz grit which is integrally applied, cured and sealed onto the surface for superior slip resistant footing



FIBERGRATE® MOLDED GRATING WITH CORVEX® RESIN SYSTEM

DETAILS

1" Deep x 1-1/2" Square Mesh

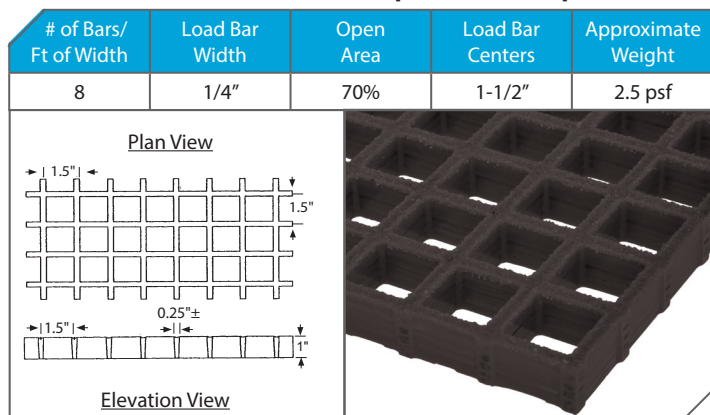

Section Properties per Ft of Width: $A = 1.71 \text{ IN}^2$ $I = 0.14 \text{ IN}^4$ $S = 0.29 \text{ IN}^3$

1-1/2" Deep x 1-1/2" Square Mesh

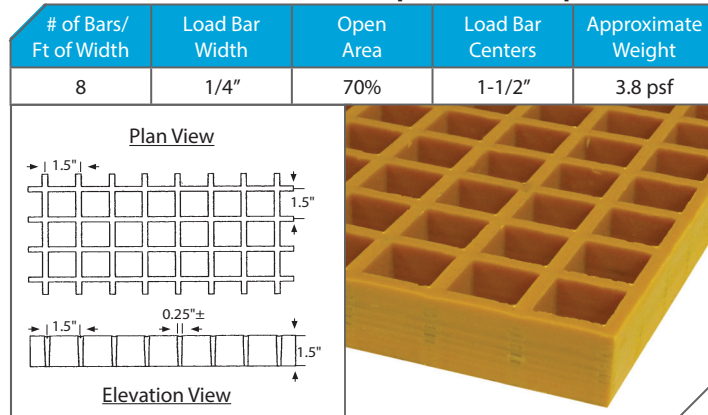

Section Properties per Ft of Width: $A = 2.85 \text{ IN}^2$ $I = 0.51 \text{ IN}^4$ $S = 0.65 \text{ IN}^3$

RUBBER FEET FOR MOLDED GRATING



Specially designed rubber feet are an economical way to create a raised, ergonomic grating workmat for use around maintenance equipment, machines, lathes and in wet areas. With the rubber feet, facilities have a cost-effective solution to elevate grating needed for drainage or water flow and safe, ergonomic platforms. The feet can be utilized on all depths of molded grating from 1", 1-1/2" and 2" in any shape or configuration. The work mats can also be customized to worker resiliency preferences, just add more feet to increase the stiffness. The feet raise the grating 1/2" above the ground, and along with the open mesh, protect workers by allowing chips and fluids to fall below the standing surface eliminating slip and fall hazards.

SPECIFICATIONS

Resin

Corvex®:

This newly improved isophthalic polyester resin system outperforms a number of competitive fiberglass and metal products and meets the requirements for corrosion resistance found in industrial, chemical processing and water/wastewater applications. *This upgraded formulation has replaced IFR, CP-84 and FS-25 resins.* Flame Spread: ASTM E84 rating of 25 or less. Certifications: DNV Type Approval No. F-16856; meets the USCG requirements for general fire rating*.

*For specific requirements and questions, please contact technical services.

Colors

Dark Gray

Yellow

Size

| DEPTH | MESH | PANEL SIZES |
|--------|-----------------|--|
| 1" | 1-1/2" x 1-1/2" | 3' x 10' / 4' x 8' / 4' x 12' |
| 1-1/2" | 1-1/2" x 1-1/2" | 3' x 10' / 4' x 8' / 4' x 12' / 5' x 10' |

Surface

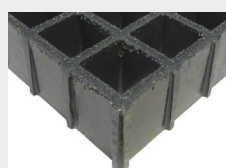

Integrally Applied Grit:

The optional grip top of Fibergrate® grating has a quartz grit which is integrally applied, cured and sealed onto the surface providing excellent slip resistant footing.

PRODUCT DATA SHEET

LOAD CHARTS PRODUCTS: 1" Deep & 1-1/2" Deep Fibergrate® Molded Grating with 1-1/2" Square Mesh

| UNIFORM LOAD TABLE - DEFLECTION IN INCHES | | | | | | | | | | | MAX RECOM. LOAD (psf) | ULTIMATE CAPACITY (psf) |
|---|------------|------------|------|------|------|------|------|------|------|------|-----------------------|-------------------------|
| CLEAR SPAN (in) | DEPTH (in) | LOAD (psf) | | | | | | | | | | |
| | | 50 | 65 | 100 | 150 | 200 | 300 | 500 | 1000 | 2000 | | |
| 12 | 1" | <.01 | <.01 | <.01 | <.01 | <.01 | 0.02 | 0.04 | 0.08 | 0.16 | 1420 | 7120 |
| | 1-1/2" | <.01 | <.01 | <.01 | <.01 | <.01 | 0.01 | 0.02 | 0.04 | 0.07 | 3200 | 16000 |
| 18 | 1" | 0.02 | 0.02 | 0.04 | 0.06 | 0.08 | 0.11 | 0.20 | 0.38 | -- | 630 | 3170 |
| | 1-1/2" | <.01 | <.01 | 0.01 | 0.02 | 0.03 | 0.04 | 0.07 | 0.14 | 0.28 | 1420 | 7100 |
| 24 | 1" | 0.06 | 0.08 | 0.12 | 0.19 | 0.25 | 0.37 | -- | -- | -- | 350 | 1780 |
| | 1-1/2" | 0.02 | 0.03 | 0.04 | 0.06 | 0.08 | 0.12 | 0.21 | 0.42 | -- | 800 | 4000 |
| 30 | 1" | 0.14 | 0.18 | 0.27 | 0.41 | -- | -- | -- | -- | -- | 220 | 1140 |
| | 1-1/2" | 0.05 | 0.06 | 0.09 | 0.14 | 0.18 | 0.27 | 0.46 | | | 510 | 2560 |
| 36 | 1" | 0.31 | 0.40 | -- | -- | -- | -- | -- | -- | -- | 150 | 790 |
| | 1-1/2" | 0.1 | 0.13 | 0.20 | 0.30 | 0.40 | -- | -- | -- | -- | 350 | 1770 |
| 42 | 1" | 0.49 | -- | -- | -- | -- | -- | -- | -- | -- | 110 | 580 |
| | 1-1/2" | 0.17 | 0.22 | 0.34 | -- | -- | -- | -- | -- | -- | 260 | 1300 |
| 48 | 1-1/2" | 0.28 | 0.37 | -- | -- | -- | -- | -- | -- | -- | 200 | 1000 |
| 54 | 1-1/2" | 0.42 | -- | -- | -- | -- | -- | -- | -- | -- | 150 | 790 |

| MOLDED GRATING CONCENTRATED POINT LOAD TABLES - Deflection in Inches | | | | | | | | |
|--|------------|-----------|------|------|------|------|------|------|
| CLEAR SPAN (in) | DEPTH (in) | LOAD (lb) | | | | | | |
| 50 | 100 | 200 | 300 | 500 | 1000 | 2000 | | |
| 18 | 1 | <.01 | 0.01 | 0.03 | 0.04 | 0.07 | 0.14 | 0.27 |
| | 1-1/2* | <.01 | <.01 | 0.01 | 0.02 | 0.03 | 0.06 | 0.13 |
| 24 | 1 | 0.01 | 0.03 | 0.05 | 0.08 | 0.13 | 0.26 | -- |
| | 1-1/2* | <.01 | 0.01 | 0.02 | 0.03 | 0.06 | 0.12 | 0.23 |
| 30 | 1 | 0.03 | 0.05 | 0.1 | 0.15 | 0.26 | -- | -- |
| | 1-1/2* | 0.01 | 0.02 | 0.04 | 0.06 | 0.1 | 0.2 | -- |
| 36 | 1 | 0.03 | 0.07 | 0.14 | 0.2 | 0.34 | -- | -- |
| | 1-1/2* | 0.02 | 0.03 | 0.06 | 0.09 | 0.15 | 0.3 | -- |
| 42 | 1 | 0.06 | 0.12 | 0.23 | 0.35 | -- | -- | -- |
| | 1-1/2* | 0.02 | 0.04 | 0.09 | 0.13 | 0.22 | 0.44 | -- |
| 46 | 1 | 0.07 | 0.14 | 0.28 | 0.42 | -- | -- | -- |
| 48 | 1-1/2* | 0.03 | 0.06 | 0.12 | 0.18 | 0.29 | -- | -- |
| 54 | 1-1/2* | 0.04 | 0.07 | 0.15 | 0.22 | 0.37 | -- | -- |
| 58 | 1-1/2* | 0.04 | 0.08 | 0.17 | 0.25 | 0.42 | -- | -- |

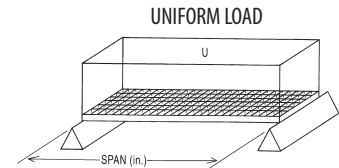

CONCENTRATED POINT LOAD

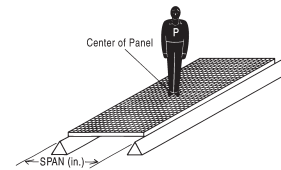

| CONCENTRATED LINE LOAD TABLE - DEFLECTION IN INCHES | | | | | | | | | MAX RECOM. LOAD (lbs/ft) | ULTIMATE CAPACITY (lbs/ft) |
|---|--------|-----------------------|------|------|------|------|------|------|-----------------------------------|----------------------------------|
| CLEAR SPAN (in) | | LOAD (lb/ft of width) | | | | | | | | |
| | | 50 | 100 | 200 | 300 | 500 | 1000 | 2000 | | |
| 12 | 1" | <.01 | 0.01 | 0.03 | 0.04 | 0.06 | 0.13 | -- | 710 | 3560 |
| | 1-1/2" | <.01 | <.01 | 0.01 | 0.02 | 0.03 | 0.05 | 0.11 | 1600 | 8000 |
| 18 | 1" | 0.02 | 0.04 | 0.08 | 0.12 | 0.20 | 0.41 | -- | 470 | 2370 |
| | 1-1/2" | 0.01 | 0.02 | 0.03 | 0.05 | 0.08 | 0.15 | 0.3 | 1060 | 5330 |
| 24 | 1" | 0.05 | 0.1 | 0.2 | 0.3 | 0.49 | -- | -- | 350 | 1780 |
| | 1-1/2" | 0.02 | 0.03 | 0.07 | 0.1 | 0.17 | 0.33 | -- | 800 | 4000 |
| 30 | 1" | 0.09 | 0.18 | 0.35 | -- | -- | -- | -- | 280 | 1420 |
| | 1-1/2" | 0.03 | 0.06 | 0.12 | 0.18 | 0.29 | -- | -- | 640 | 3200 |
| 36 | 1" | 0.16 | 0.33 | -- | -- | -- | -- | -- | 230 | 1180 |
| | 1-1/2" | 0.05 | 0.11 | 0.21 | 0.32 | -- | -- | -- | 530 | 2660 |
| 42 | 1" | 0.26 | 0.45 | -- | -- | -- | -- | -- | 200 | 1010 |
| | 1-1/2" | 0.08 | 0.16 | 0.32 | 0.47 | -- | -- | -- | 450 | 2280 |
| 46 | 1" | 0.32 | -- | -- | -- | -- | -- | -- | 180 | 900 |
| 48 | 1-1/2" | 0.11 | 0.23 | 0.45 | -- | -- | -- | -- | 400 | 2000 |
| 54 | 1-1/2" | 0.15 | 0.3 | -- | -- | -- | -- | -- | 350 | 1770 |

CONCENTRATED LINE LOAD

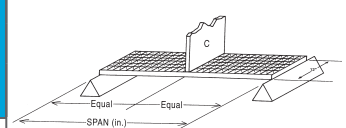

Phone: 800-852-6013



www.tremcoroofing.com



SafetySolutions@tremcoinc.com

©2016 Fibergrate Composite Structures Inc. - Corvex Product Data Sheet-02/17.PDF

Fibergrate Composite Structures believes the information contained here to be true and accurate. Fibergrate makes no warranty, expressed or implied based on this literature and assumes no responsibility for consequential or incidental damages in the use of these products and systems described, including any warranty of merchantability or fitness. Information contained here is for evaluation only.

Dynarail® FRP Safety Ladder

AVAILABLE THROUGH
TREMCO
 ROOFING & BUILDING MAINTENANCE



Combining corrosion resistance, long life and a low maintenance design, Dynarail® ladder systems are superior to conventional metallic systems. These advanced systems are designed and manufactured to be easily installed with no guesswork involved. Components are lightweight and easy to fabricate. Savings on labor and equipment often make the total installed cost of Dynarail ladders comparable to that of steel. Combining its low cost of installation with low maintenance and long life, Dynarail ladders offers a life cycle cost that is significantly lower than that of its counterparts.

Dynarail ladder components are manufactured using the proven Fibergrate pultrusion process. In this process, continuous fiber rovings and mat as well as a synthetic veil are mechanically drawn through a resin bath and shaped through a series of forming guides, then pulled through a heated die. All ladders used in outdoor applications also have a proprietary, secondarily applied UV Coating to ensure a long life even in the harshest UV environments.

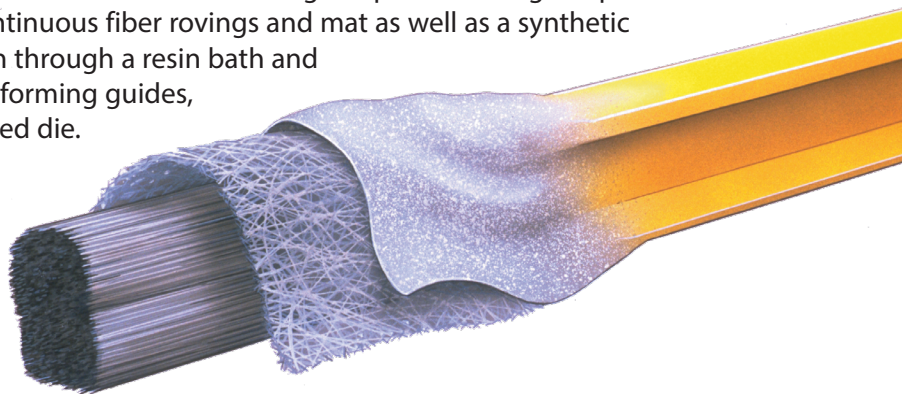

Dynarail Ladder Benefits



Corrosion Resistant: Dynarail® fiberglass ladder systems are known for their ability to provide corrosion resistance in the harshest environments and chemical exposures.



Electrically & Thermally Non Conductive: Fiberglass is electrically non conductive for safety and has low thermal conductivity which results in a more comfortable product when physical contact occurs.



Low Install Cost: Due to ease of fabrication and lightweight, FRP ladders eliminate the need for heavy lifting equipment. Components are also labeled with tags that correspond to engineering drawings to ensure time-efficient and accurate installation.



Slip Resistant: Ladder rungs include heavily serrated flutes for positive, slip resistant footholds; also ungritted rungs are easy on the hands, while still ensuring safety.



Low Maintenance: The corrosion resistant properties of Fibergrate's FRP products reduce or eliminate the need for sandblasting, scraping and painting. Products are also easily cleaned with a high pressure washer.



UV Protection: UV inhibitors in the resin matrix, along with a synthetic surfacing veil, provide optimum protection from the effects of UV weathering. (An optional UV coating is required for installations with intense UV exposure.)

Specifications

Safety Ratings

Meets OSHA Requirements:

- | | | |
|-------------|------------------|-----------|
| • 1926.1050 | • 1910.28(b)(1) | Canada |
| • 1926.1051 | • 1910.29(b) | • 1910.27 |
| • 1926.1053 | USA | |
| • 1926.23 | • 1910.28(b) (9) | |

ANSI

- A14.3-2008

Ontario Ministry of Labor

- Engineering Data Sheet 2-04

Ontario Occupational and Safety Act

- Reg 851 (18)

Resin Systems

ISOFR

- Isophthalic polyester resin formulation
- Low flame spread rating of 25 or less
- Designed for applications where there is moderate exposure to corrosive elements

VEFR

- Vinyl ester resin system with a flame spread of 25 or less for dependable resistance to both acidic and alkaline environments

Size

Available heights:

- 8'
- 10'
- 12'
- 14'
- 16'
- 18'
- 20'
- 24'

Dynarail® FRP Safety Ladder

The innovative Dynarail® fiberglass reinforced plastic (FRP) safety ladder and cage system meets or exceeds OSHA requirements. Dynarail cage components are shipped in compact kit form - not large, bulky units prone to damage.

Ladders are stocked in standard heights of 8', 10', 12', 14', 16', 18', 20' and 24' and are available in taller heights using splice kits. Ladders can be ordered in a LADDER ONLY format or as a KIT that includes the ladder as well as the appropriate number of wall mounts.

Safety features are built-in from the ground up. Special clip angles have been developed to securely anchor the ladder. Intermediate stand-off brackets laterally stabilize the ladder to the supporting structure on 6' centers. Ladder rungs include heavily serrated flutes for slip resistant footholds.

Technical Data (Except where noted, all materials are yellow vinyl ester, fire retardant - VEFR)

LADDER:

| | | | |
|--|---------|---------------------------------|----------|
| Maximum length without splice | 24'-0" | Outside Diameter of rung | 1-1/4" |
| Clear inside width (inside rail to rail) | 18" | Inside Diameter of rung | 3/4" |
| Outside width (outside rail to rail) | 21-1/2" | Rail - outside width | 1-3/4" |
| Rung Spacing (center to center) | 12" | Rail - wall thickness | 1/4" |
| | | Weight per foot (approximately) | 3.0 lbs. |

| Product | Description |
|---|---|
| Bottom Wall Mount Bracket Kit* (FG 448400 ISOFR Dk Gray) <i>Required when ladder cannot be floor mounted</i> | 2-3/16" x 8" x 3/8" angle, 18" long Two per set <i>(with necessary bolt assemblies)</i> |
| Wall Mount Bracket Kit* (FG 448500 ISOFR Dk Gray) | 2-3/16" x 8" x 3/8" angle, 6" long 7" from wall to center of rung Two per set <i>(with necessary bolt assemblies)</i> |
| Floor Mount Clip Kit* (FG448700 ISOFR Dk Gray) | 4" x 4" x 3/8" angle, 2-3/4" long Two per set <i>(with necessary bolt assemblies)</i> |
| Ladder Rail Splice Kit (FG448600) | 1-1/4" Square bar splice 1-3/4" x 1/4" Square tube rail |
| 24" Wide Walk-thru Kit (FG448901.1 VEFR Yellow) | 24" Walk thru post Walk thru spacer 1.5" x 1.5" End Cap |

***NOTE:** Wall mount brackets and floor mount clips are predrilled with 9/16" diameter holes for 1/2" diameter anchor bolts only. **Anchor bolts not included.**



Dynarail® FRP Safety Ladders

Dynarail® Ladder System Data

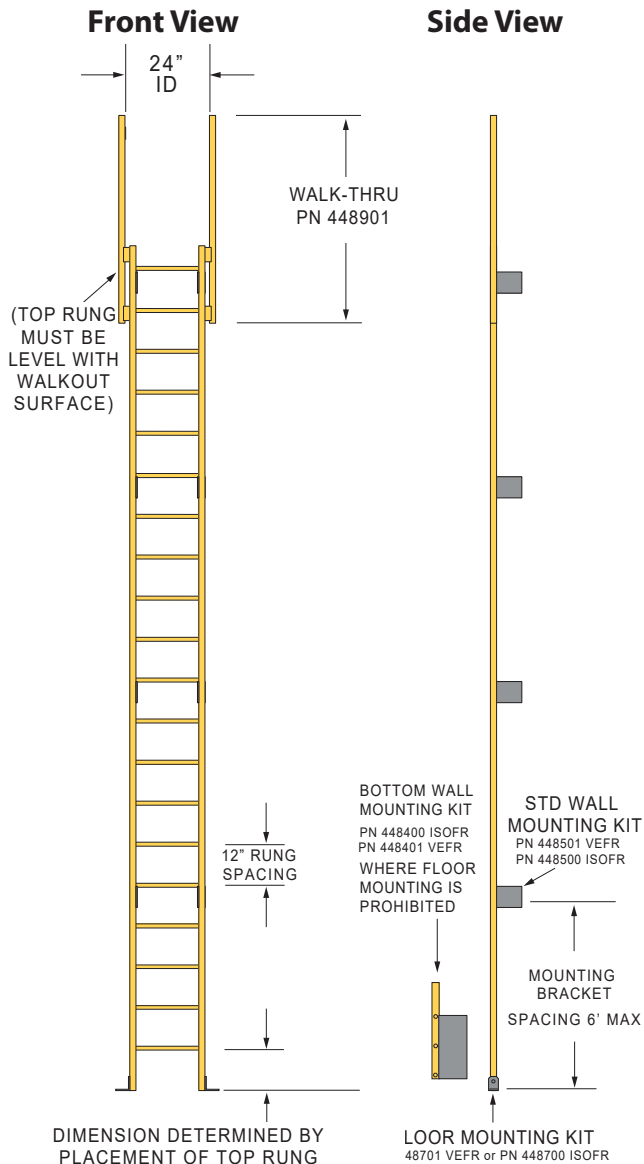

Component Selection Guide

Ladder Mounting Accessories

| Ladder Height | Floor Mount Kits Required PN 448700 ISOFR PN 448701 VEFR | Bottom Wall Mount Kits PN 448400 ISOFR PN 448401 VEFR | Wall Mount Kits Required PN 448500 ISOFR PN 448501 VEFR |
|------------------|--|---|---|
| 0" to 6" | 1 | 1 | 1 |
| 6' 6" to 12' 0" | 1 | 1 | 2 |
| 12' 6" to 18' 0" | 1 | 1 | 3 |
| 18' 6" to 24' 0" | 1 | 1 | 4 |
| 24' 6" to 30' 0" | 1 | 1 | 5 |
| 30' 6" to 36' 0" | 1 | 1 | 6 |

Note: Top rung step-off must be even with upper walking surface

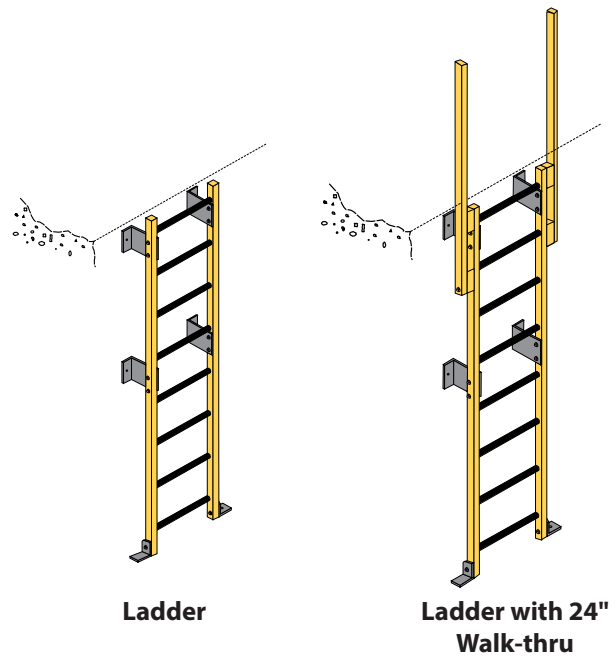

Assembly & Mounting Details

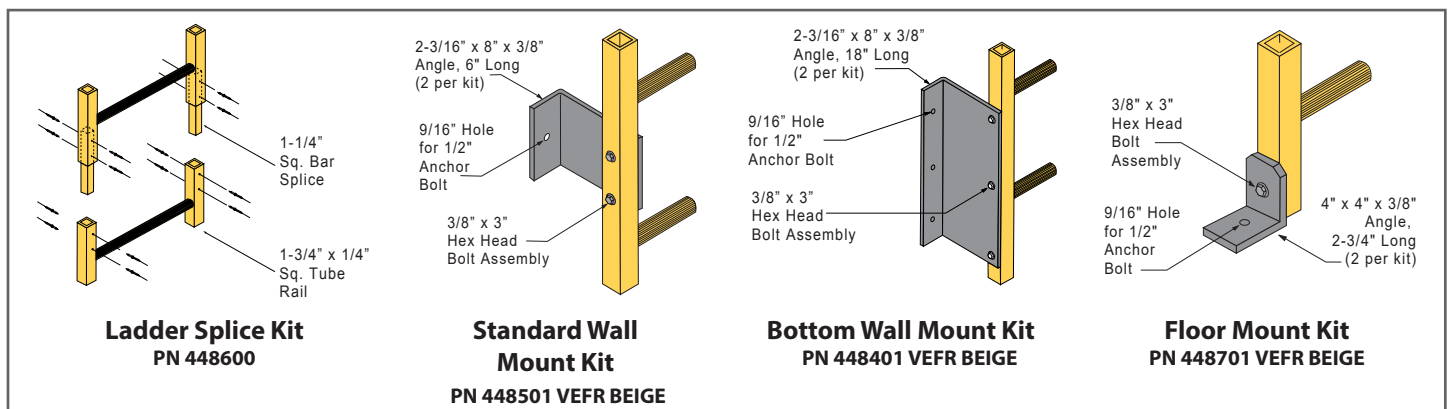

FRP Ship Stair Crossovers

AVAILABLE THROUGH
TREMCO
ROOFING & BUILDING MAINTENANCE

Fibergrate
Composite Structures
Building the World to Last®

Pre-engineered composite ship stair crossovers by Fibergrate Composite Structures provide a more cost-effective, standard solution to meet customer's special requirements that would normally necessitate a custom solution. Whether you need a ship stair crossover for a retaining wall or a walkover for a tank, they are versatile enough to solve many of the day-to-day needs of most facilities.

Fibergrate's ship stair crossovers are newly redesigned to meet the revised OSHA Standards 1910.25 for Ship Stairs and Stairs and 1910.29 for Guardrails and Stair Rail Systems. Fibergrate's crossovers also meet the IBC 2015, Section 1011.15 requirements for ship's ladders. Traditional material options such as heavy, expensive steel or stainless steel crossovers are often unsafe, costly to ship and install, and difficult to clean. Fibergrate's composite crossovers offer a better solution that will save you time and money!

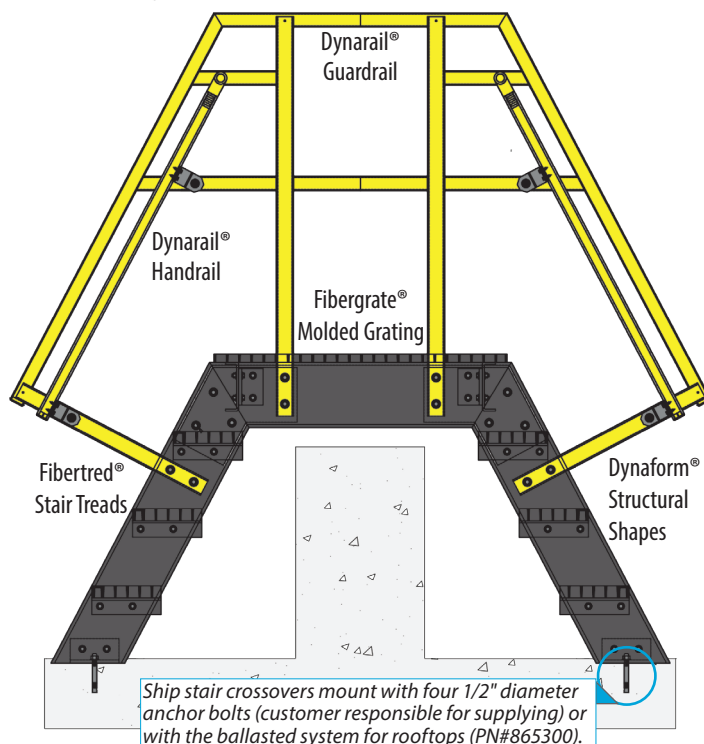

WHY USE FIBERGRATE'S SHIP STAIR CROSSOVERS?



CORROSION RESISTANT

Fibergrate composite products are known for their ability to provide corrosion resistance in the harshest environments and chemical exposures. Our products remain durable and will not rust or rot.



SLIP RESISTANT

The meniscus surface of the grating and stairs provides superior slip resistance in most environments, including oily or wet conditions.



EASY INSTALLATION

FRP ship stair crossovers are lightweight and easy to install. Fibergrate products eliminate the need for heavy lifting equipment, creating convenience and saving money.

SPECIFICATIONS

Safety Ratings

Meets OSHA Requirements:

- 1910.25
- 1910.29

Meets IBC 2015 Requirements:

- 1011.15

National Building Code of Canada

- 4.1.5.14
- 9.8.8.1
- 9.8.1-4
- 9.8.8.2
- 9.8.7

Materials of Construction

Fiberglass Reinforced Plastics (FRP)

- Fibergrate® Molded Grating & Fibertred® Molded Stair Treads with Corvex® Resin System; Dark Gray; Meniscus Surface
- Dynaform® Structural Shapes (ISOFR Resin), Dark Gray
- Dynarail® Guardrail & Handrail (ISOFR Resin with UV Coating); Yellow

Measurements

| PART # | CLEARANCE HEIGHT | APPROXIMATE WEIGHT |
|-----------|-------------------|--------------------|
| 866110.01 | 10" Clearance | 105 lbs |
| 866119.01 | 19-1/2" Clearance | 111 lbs |
| 866129.01 | 29" Clearance | 125 lbs |
| 866138.01 | 38-1/2" Clearance | 158 lbs |
| 866148.01 | 48" Clearance | 174 lbs |
| 866167.01 | 67" Clearance | 204 lbs |



Detailed Drawings

All crossovers are constructed of Fibergrate® molded grating with Corvex® resin system in dark gray with meniscus surface, dark gray molded Fibertred® stair treads with Corvex resin and meniscus surface with grit nosing, ISOFR dark gray Dynaform® structural shapes, and ISOFR yellow UV coated Dynarail® guardrail and handrail.

10" CLEARANCE GRATING PLAN

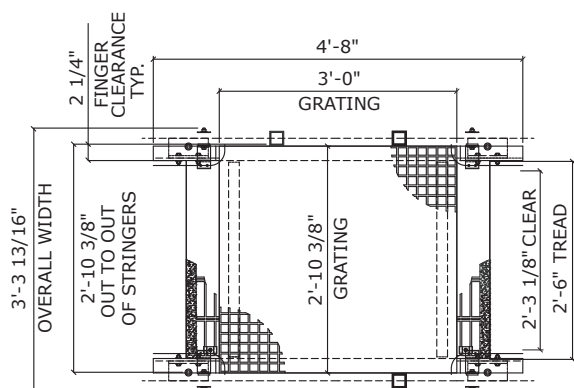

All standard crossover stairs (10", 19-1/2", 29", 38-1/2", 48" and 67" clearances) have 2'-6" wide stair treads and an overall width of 3' 3-13/16".

10" CLEARANCE
PN 866110.01

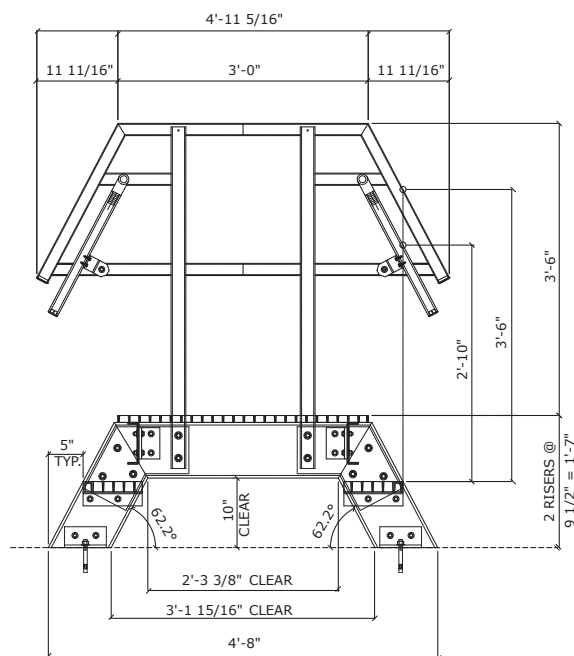

19-1/2" CLEARANCE
PN 866119.01

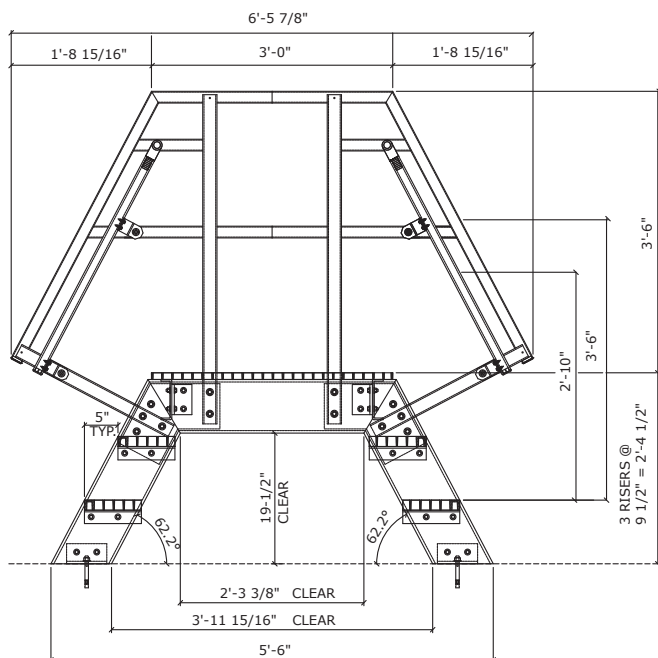

29" CLEARANCE
PN 866129.01

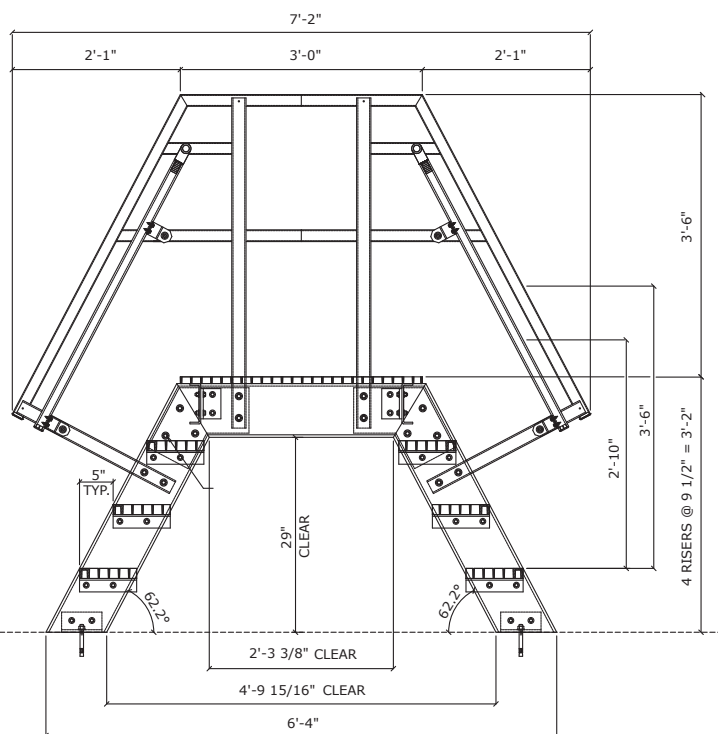

FRP Ship Stair Crossovers

38-1/2" CLEARANCE - PN 866138.01

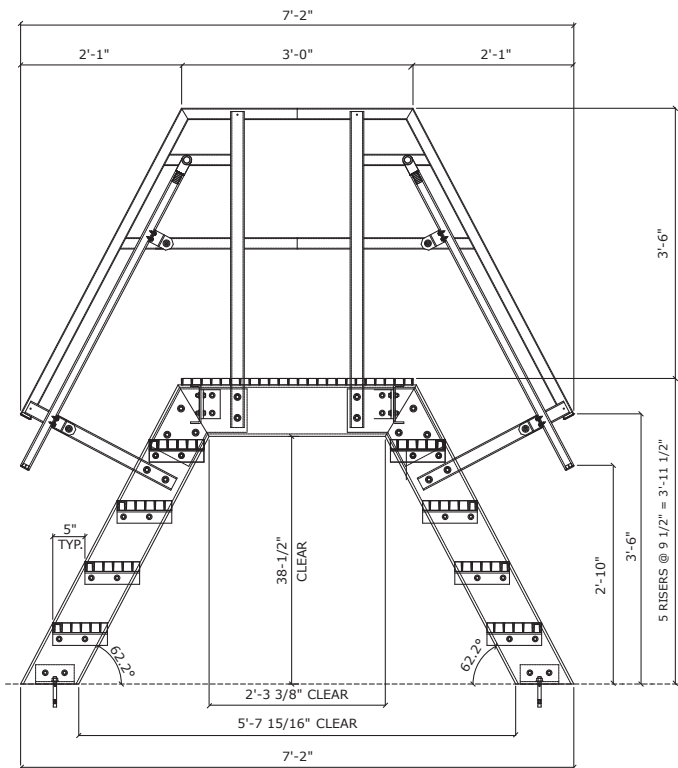

48" CLEARANCE - PN 866148.01

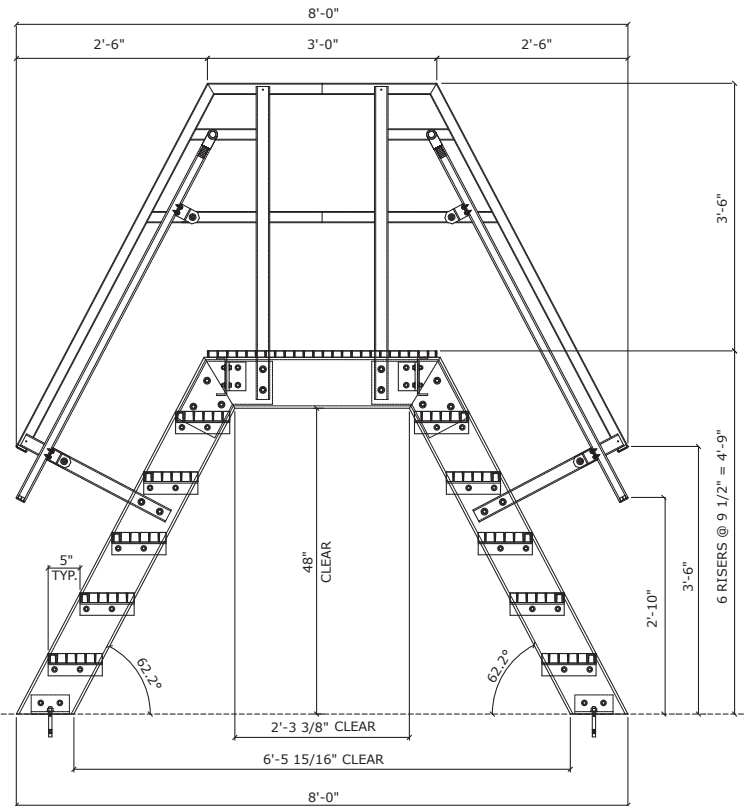

**BALLASTED ROOFTOP SYSTEM
PN#865300**

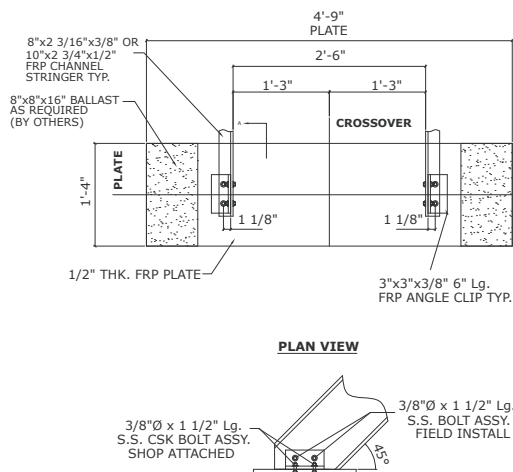

**67" CLEARANCE
PN 866167.01**

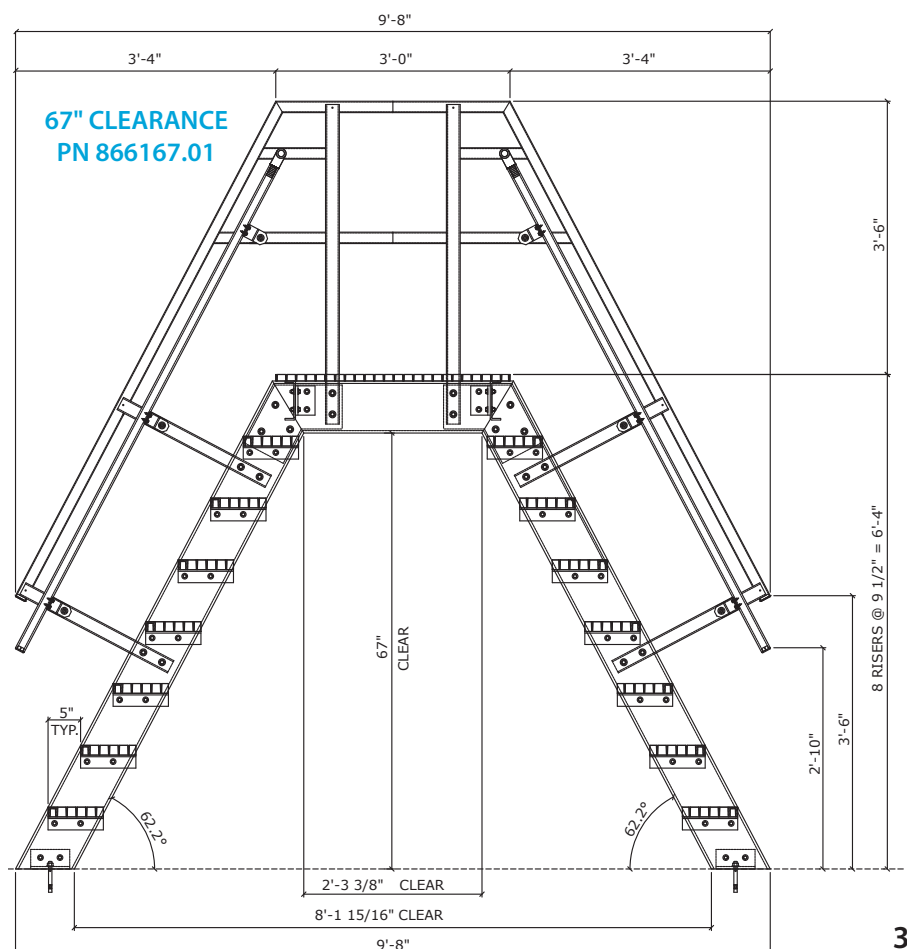

FRP Stair Crossovers

AVAILABLE THROUGH
TREMCO
ROOFING & BUILDING MAINTENANCE

Fibergrate
Composite Structures

Building the World to Last®

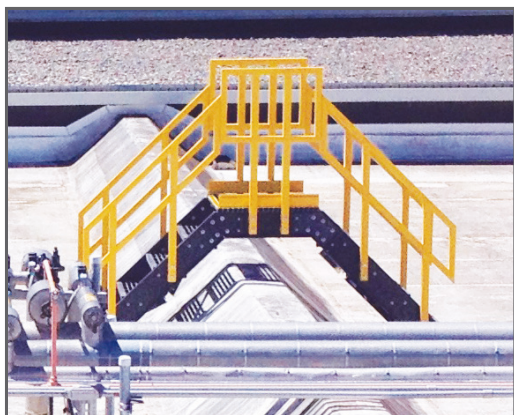

Are you tired of paying more money and having longer lead times when having to order custom crossover stairs? Now you don't have to — Fibergrate now offers a new pre-engineered, standard solution!

Fibergrate's composite stair crossovers are versatile enough to solve many of the day-to-day needs of most facilities. Whether you need a crossover for a retaining wall or a walkover over tanks, pipes, conveyors or other obstructions, Fibergrate's pre-engineered solution is offered in a variety of heights that address most standard

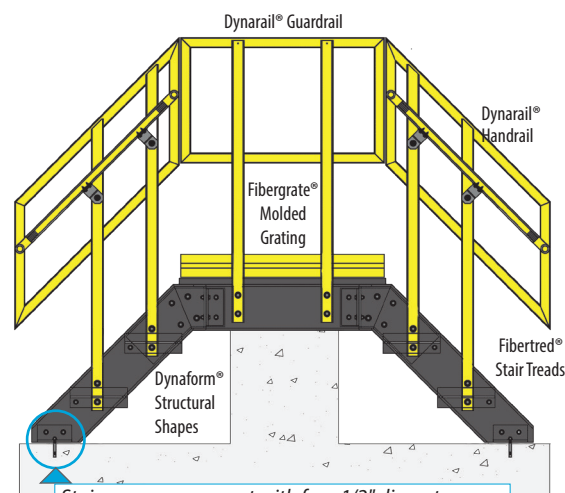

Stair crossovers mount with four 1/2" diameter anchor bolts (customer responsible for supplying) or with the ballasted system for rooftops (PN#865300).

clearances. This will save you time and money. Fibergrate's stair crossovers also provide a safer working environment. All standard systems are newly redesigned to meet the revised OSHA Standards 1910.25 for Ship Stairs and Stairs and 1910.29 for Guardrails and Stair Rail Systems. The 45° angle of climb is easy for workers to manage when carrying loads, and the surface of the stairs and platform provide slip resistant footing. A ballasted system is available for rooftop applications. Traditional material options such as heavy, expensive steel or stainless steel crossovers are often unsafe, costly to ship and install, and difficult to clean. Fibergrate's composite crossovers offer a better solution!

WHY USE FIBERGRATE'S STAIR CROSSOVERS?



CORROSION RESISTANT

Fibergrate composite products are known for their ability to provide corrosion resistance in the harshest environments and chemical exposures. Our products remain durable and will not rust or rot.



SLIP RESISTANT

The surfaces of Fibergrate's grating and stairs provide superior slip resistance in most environments, including oily or wet conditions. This improves worker safety and reduces slips and falls.



EASY INSTALLATION

FRP stair crossovers are lightweight and easy to install. Fibergrate products eliminate the need for heavy lifting equipment, creating convenience and saving money.

SPECIFICATIONS

Safety Ratings

Meets OSHA Requirements:

- 1910.25
- 1910.29

Meets IBC 2015 Requirements:

- 1011.15

National Building Code of Canada

- 4.1.5.14
- 9.8.8.1
- 9.8.1-4
- 9.8.8.2
- 9.8.7

Materials of Construction

Fiberglass Reinforced Plastics (FRP)

- Fibergrate® Molded Grating & Fibertred® Molded Stair Treads with Corvex® Resin System; Dark Gray; Meniscus Surface
- Dynaform® Structural Shapes (ISOFR Resin), Dark Gray
- Dynarail® Guardrail & Handrail (ISOFR Resin with UV Coating); Yellow

Measurements

| PART # | CLEARANCE HEIGHT | APPROXIMATE WEIGHT |
|-----------|-------------------|--------------------|
| 866210.01 | 10" Clearance | 200 lbs |
| 866219.01 | 19-1/2" Clearance | 240 lbs |
| 866229.01 | 29" Clearance | 266 lbs |
| 866238.01 | 38-1/2" Clearance | 320 lbs |
| 866248.01 | 48" Clearance | 374 lbs |
| 866265.01 | 65" Clearance | 447 lbs |

FRP Stair Crossovers

38-1/2" CLEARANCE
PN#866238.01

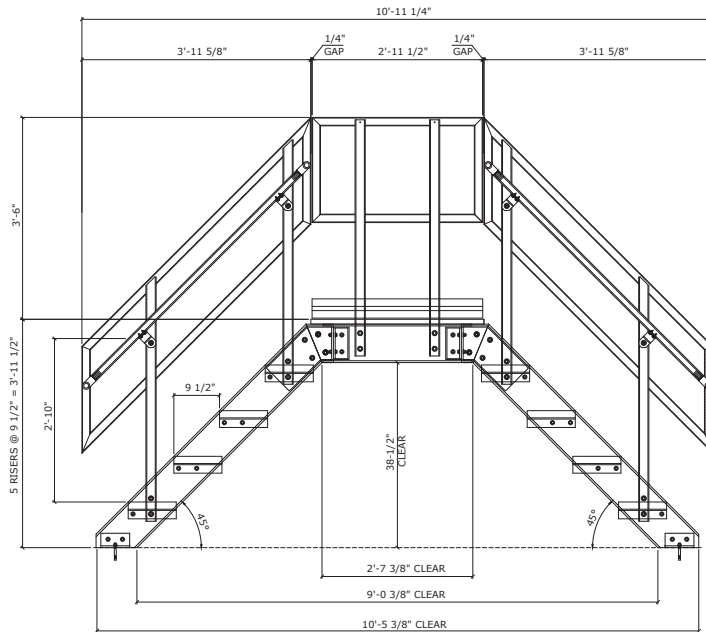

48" CLEARANCE
PN#866248.01

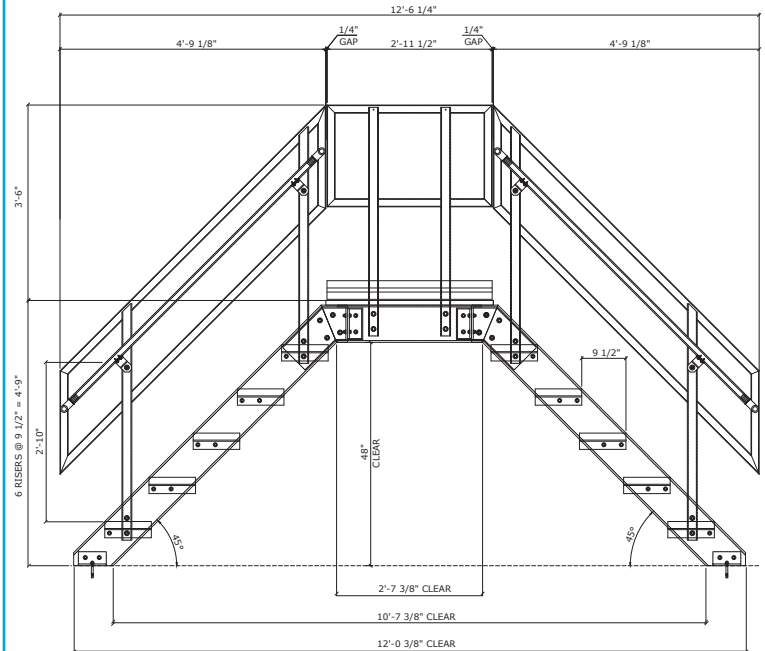

65" CLEARANCE
PN#866265.01

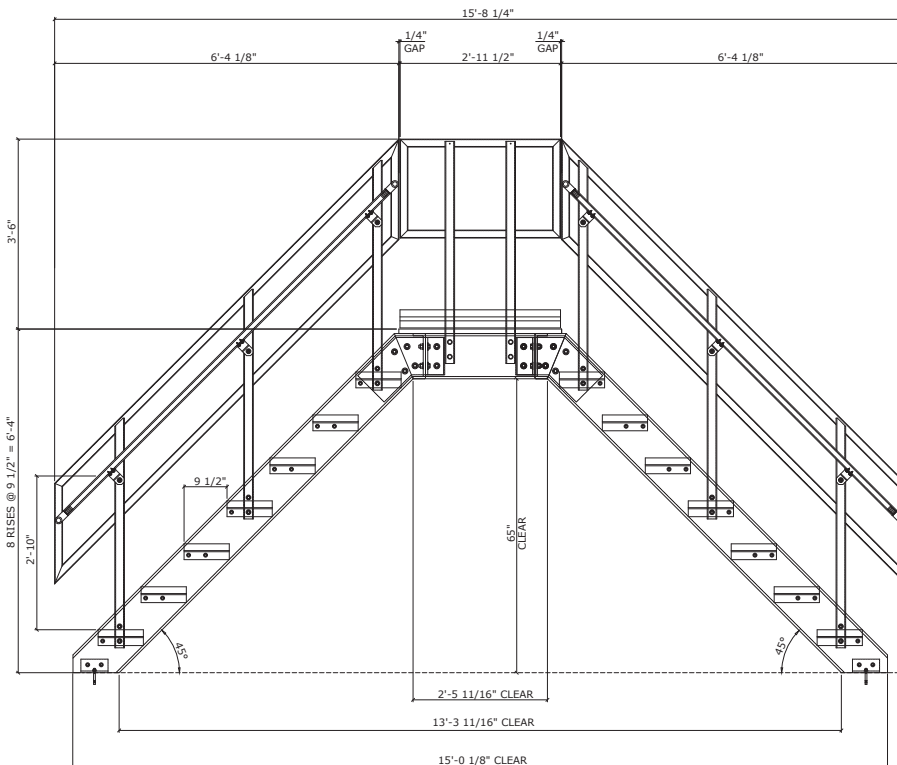

BALLASTED ROOFTOP SYSTEM
PN#865300

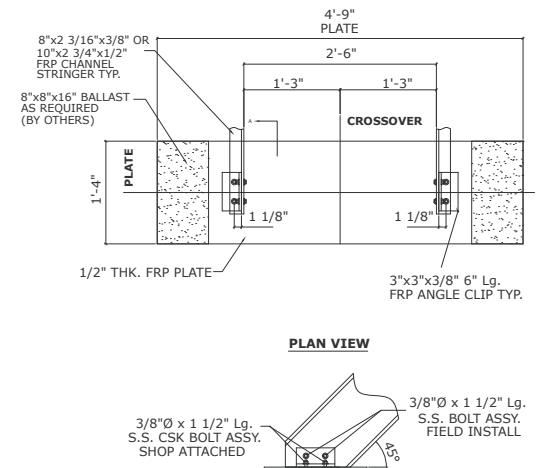

PRODUCT DATA SHEET

AVAILABLE THROUGH
TREMCO
ROOFING & BUILDING MAINTENANCE

Fibergrate
Composite Structures
Building the World to Last™

FIBERPLATE® STAIR TREAD COVERS



Fiberplate® stair tread covers are a convenient way to provide solid, slip resistant footing for existing treads that are still structurally sound. Stair tread covers may be installed over wood, concrete or metal steps. Standard color is dark gray with a highly visible safety yellow nosing for industrial applications.

An integral aluminum oxide grit-top surface provides secure footing for maximum safety and a highly durable tread. Reinforced with a woven glass mat for durability and impact resistance, these tread

covers come in 8", 9", 10", 11" and 12" depths. The standard thickness is 1/8", with 1/4" thick covers available for heavy duty applications. Standard 12' panels are easily cut to size during installation, or are available pre-cut to custom lengths.

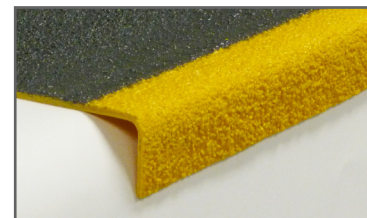

BENEFITS



Slip Resistant

The integrally applied aluminum oxide quartz grit top surface of stair treads covers have unmatched slip resistance for improved worker safety.



Low Install Cost

Due to ease of fabrication and lightweight, FRP stair tread covers eliminate the need for heavy lifting equipment and make installation easy.



Corrosion Resistant

Fiberplate® fiberglass stair tread covers are known for their ability to withstand the harshest environments and remain durable.

INSTALLATION INFORMATION

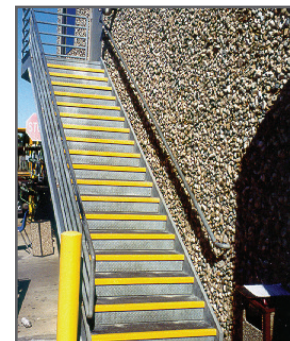
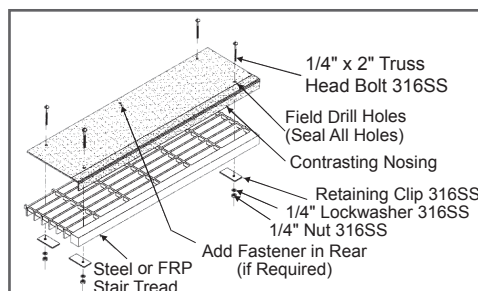
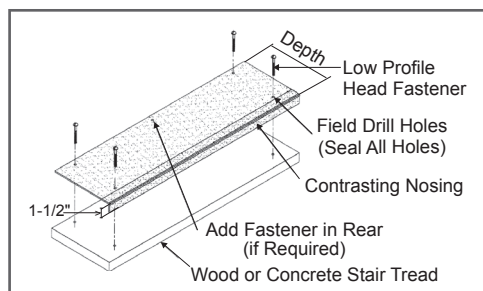

SPECIFICATIONS

Resin

Corvex®:

This newly improved isophthalic polyester resin system outperforms a number of competitive fiberglass and metal products and meets the requirements for corrosion resistance found in industrial, chemical processing and water/wastewater applications. *This upgraded formulation has replaced IFR, CP-84 and FS-25 resins.* Flame Spread: ASTM E84 rating of 25 or less. Certifications: DNV Type Approval No. F-16856; meets the USCG requirements for general fire rating*.

*For specific requirements and questions, please contact technical services.

Colors

Dark Gray

Yellow

Size

| THICKNESS | TREAD DEPTHS | STD. LENGTH |
|-----------|-----------------------|-------------|
| 1/8" | 8", 9", 10", 11", 12" | 12' |
| 1/4" | 8", 9", 10", 11", 12" | 12' |

Surface



Aluminum Oxide Grit:

Aluminum oxide quartz grit which is integrally applied, cured and sealed onto the surface for superior slip resistant footing



Skylight Guards

A non-penetrating skylight fall protection system.

FEATURES

Meets or exceeds National and California OSHA regulations.

No drilling required; unique compression system fastens to skylight frame.

Does not compromise roof membrane or skylight weatherproofing.

Will not void your roof warranty.

Installs with basic tools in 30 minutes.

Constructed of 1/4" diameter 4" x 4" galvanized mesh.

Customizable sizes available.

Optional Skylight Demarcation Kit.

BENEFITS

- Structural load: 400lbs. minimum, in any direction to all components in accordance with California OSHA Regulations.
- Non-penetrating design eliminates possibility of damage to the rooftop, that could result from drilling.
- Uncompromised rooftop while maintaining a safe work environment for your employees.
- Protection from injuries and falls while keeping roof warranty intact.
- Fast installation
- Designed to protect against injuries and deaths around skylight openings.
- Designed to fit a wide variety of skylight shapes and dimensions (*square, rectangular, and flat*)
- Provides visual location of skylights on rooftops (*available for square, rectangular, and flat guards*).

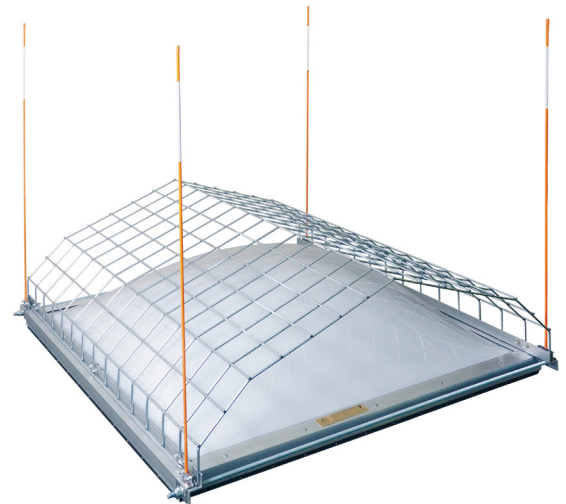
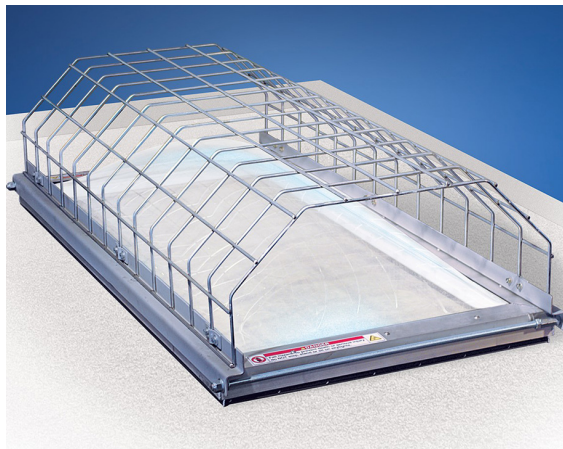

DESCRIPTION

The Tremco Skylight Guard is specifically designed to protect against injuries and deaths around skylight openings. The non-penetrating design is available in customizable sizes and features a unique compression attachment system. It installs in minutes and since there is no drilling required, you'll keep your surfaces uncompromised while maintaining a safe work environment for your employees.

TECHNICAL SUPPORT

Your local Tremco Representative, working with the Technical Service Staff, can help analyze conditions and needs to develop recommendations for special applications.

TREMCO
ROOFING & BUILDING MAINTENANCE

www.tremcoroofing.com
3735 Green Road
Beachwood, Ohio 44122
1.800.852.6013

50 Beth Nealson Drive
Toronto, Ontario M4H 1M6
1.800.668.9879

Tremco is a US Registered trademark of Tremco Incorporated.

The information provided on this data page supersedes all previous data concerning this product and its application. The Statements provided concerning the materials shown are intended solely as a general guide for material usage and are believed to be true and accurate. Since the manner of use is beyond our control, Tremco DOES NOT MAKE NOR DOES IT AUTHORIZE ANY WARRANTY OF MERCHANTABILITY OR FITNESS FOR ANY PURPOSE, OR ANY OTHER WARRANTY, GUARANTEE OR REPRESENTATION, EXPRESSED OR IMPLIED, CONCERNING THIS MATERIAL EXCEPT THAT IT CONFORMS TO TREMCO'S PRODUCT SAMPLE. Buyer and user accept the product under those conditions and assume the risk of any failure, injury of person or property and loss or liability resulting from the handling, storage or use of the product, whether or not it is handled, stored, used in accordance with directions or specifications. UNDER NO CIRCUMSTANCE SHALL TREMCO BE LIABLE FOR CONSEQUENTIAL OR INCIDENTAL DAMAGES ARISING FROM ANY BREACH OF WARRANTY. IN ALL CASES, TREMCO'S LIABILITY IS LIMITED, AT TREMCO'S OPTION, TO THE REPLACEMENT OF GOODS, OR THEIR VALUE, PROVEN TO BE DEFECTIVE IN MANUFACTURING.

Skylight Guard XL

A non-penetrating safety solution for large skylights.

The Tremco Skylight Guard XL is specifically designed to protect against injuries and deaths around oversized skylight openings. The non-penetrating design features rubber padded feet for skid-resistance and low roof pressure (3lbs per square inch). It installs easily and since there is no drilling required, you'll keep your surfaces uncompromised while maintaining a safe work environment for your employees.



FEATURES

- **No attachment required.**
- **Fits 6ft x 6ft to 8ft x 8ft Skylights with a maximum height of 30in from the roof surface.**
- **Meets and exceeds OSHA 1910.29 (e), CAL OSHA 3212(b) & Canada OS&H.**
- **Galvanized Pipe, Fittings & 1/4" Steel Wire Mesh for excellent corrosion resistance.**
- **Optional Extension Kit for Dual Skylights or Runs.**
- **Easy to assemble.**

DUAL 8ft. SKYLIGHT WITH EXTENSION KIT

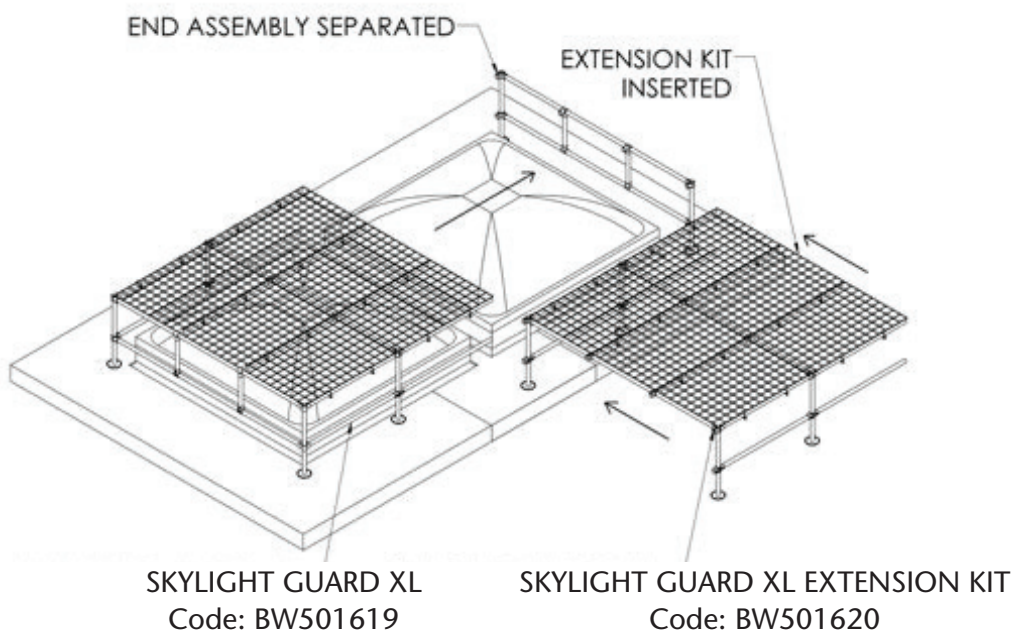

ADDITIONAL SAFETY SOLUTIONS

AVAILABLE THROUGH
TREMCO
ROOFING & BUILDING MAINTENANCE



FRP DYNARAIL® SAFETY LADDERS

DynaRail® Safety Ladder Systems combine a corrosion resistant, low maintenance design to ensure a long life cycle. Ladder rungs include heavily serrated flutes for slip resistant footholds that are easy on the hands while ensuring safety. Our system is designed and manufactured to be easily installed with no guesswork involved. Components are lightweight and easy to fabricate, which saves you on labor and equipment. UV inhibitors in the resin along with a secondary UV coating maximize protection from the effects of UV weathering. The Dynarail safety ladder system meets or exceeds all OSHA requirements.



DYNAROUND HATCH GUARD

DynaRound Hatch Guard provides a non-penetrating guard solution for safe entry and exit through roof access hatches. The adjustable self-closing gate prevents accidental entrance when hatch is open. The DynaRound Hatch Guard mounts directly to the roof hatch with a compression fit design so no drilling is necessary, which means the rooftop waterproofing system is not compromised.

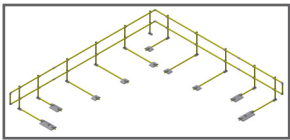

DYNAROUND RG™ (ROOF GUARD)

DynaRound RG™ Roof Guard ballasted rooftop guardrail system is designed for safety and fall protection on rooftop applications. Each system is made of durable, corrosion-resistant fiberglass reinforced plastic (FRP) composite uprights and non-FRP counterbalance weights and connector components. DynaRound RG provides the utmost in safety by protecting against injuries or death from accidental falls from the roof. This system meets all applicable safety standards in the U.S. and Canada to protect individuals on rooftop surfaces.

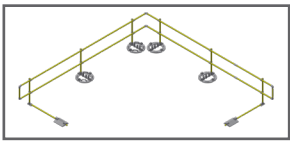

DYNAROUND RG SLIMLINE™ (ROOF GUARD)

Fibergrate's ballasted rooftop guardrail system, DynaRound RG Slimline™, provides safety and fall protection on rooftop applications with fewer counterbalance bases than DynaRound RG. Similar to our DynaRound RG system, each Slimline system is made of durable, weather-resistant fiberglass reinforced plastic (FRP) composite uprights and rails, galvanized steel base weights, and galvanized connector components. This system meets applicable safety standards in the U.S. and Canada to protect people working at heights.



DYNAWEIGHT FALL PREVENTION SYSTEM

DynaWeight Fall Protection System is the perfect solution for fall protection when circumstances require non-penetrating versatility. This system is tested and approved for use on flat rooftop surfaces (single ply, BUR, concrete, modified bitumen membranes, AlphaGuard™ BIO, AlphaGuard™ MT/MTS, and AlphaGuard™ PUMA), with a maximum incline of 5 degrees. It provides tie off options for two people if used for fall restraint or one person for fall arrest; sets up quickly and is easy to move. The DynaWeight Fall Protection System is corrosion resistant and meets all applicable safety standards in the U.S. and Canada to protect individuals on rooftop surfaces.



DYNAROUND WARNING LINES

DynaRound Warning Lines available in a heavy and light duty design. Our heavy-duty warning line systems can be used as a permanent warning system with heavy-duty galvanized base plates, plastic coated steel cable, and plastic pennants. The heavy-duty stanchions and bases are designed to withstand years of use. The standard system includes three stanchions, three bases, and 100' feet of plastic coated steel cable with flags. Our light duty warning line system can be used as a temporary warning system. This system includes three folding stanchions, 100' of nylon flagged line. Both systems meet all applicable safety standards in the U.S. and Canada to protect individuals on rooftop surfaces.



CORVEX® MOLDED GRATING WITH RUBBER FEET

Molded Walkway Grating is made with a unique Corvex resin system that outperforms many competitive fiberglass and metal products. Our molded grating is corrosion resistant, lightweight, slip resistant, and easy to install. Specially designed rubber feet can be added to molded grating, elevating it 1/2" above the surface, offering an economical raised walkway solution for use around maintenance equipment, machines, wet areas, and rooftop walkway areas.



CROSSOVERS

Our FRP Crossovers are pre-engineered and both corrosion- and slip-resistant. Available in a variety of heights that address most standard clearances, these Crossovers provide a cost-effective, safe solution over many rooftop obstructions. Crossover systems create a safe working environment, are lightweight, easy to install and designed to meet all applicable safety standards in the U.S. and Canada.

All Fibergrate Roof Top Safety Solutions are available through Tremco Roofing and Building Maintenance



Phone: 800-852-6013



www.tremcoroofing.com



SafetySolutions@tremcoinc.com

©2018 Fibergrate Composite Structures Inc. - DynaRound SlimLine - Product Data Sheet-11/18-1.0

Fibergrate Composite Structures believes the information contained here to be true and accurate. Fibergrate makes no warranty, expressed or implied based on this literature and assumes no responsibility for consequential or incidental damages in the use of these products and systems described, including any warranty of merchantability or fitness. Information contained here is for evaluation only.

TREMCO
ROOFING & BUILDING MAINTENANCE